



2021-2022 TRAILER PACKAGES

Consult, Design, Deliver



ezstak.com
315.595.3300



MADE IN AMERICA

Our ambitions are global, but our storage systems are made local.



CUSTOMER CARE

With our Customer Care Program, you'll hear from us right away.



LIFETIME WARRANTY

The quality of our products ensures Limited Lifetime Warranty.



TABLE OF CONTENTS

	Page #
12' Trailers	3
14' Trailers	4-6
16' Trailers	7-10
18' Trailers	11
20' Trailers	12-19
24' Trailers	20-21
25' Trailers	22
28' Trailers	23-25
30' Trailers	26-29
44' Trailers	30
48' Trailers	31-32
53' Trailers	33-37
Accessories	38

NOW OFFERING A COLLECTION OF PRE-CONFIGURED TRAILER PACKAGES



APPROVED BY INDUSTRY PROFESSIONALS

Packages with this stamp have been approved by professionals in the Construction and Utility industry.



SIMPLIFIED TRAILER DESIGN

Choosing one of our pre-configured trailer packages is a great start for designing your interior and exterior layout.



CHOOSE FROM 12 TRAILER SIZES

We offer packages to fit in 12 different trailer lengths, from 12ft up to 53ft.

12' TRAILER

PACKAGE NUMBER: 5089

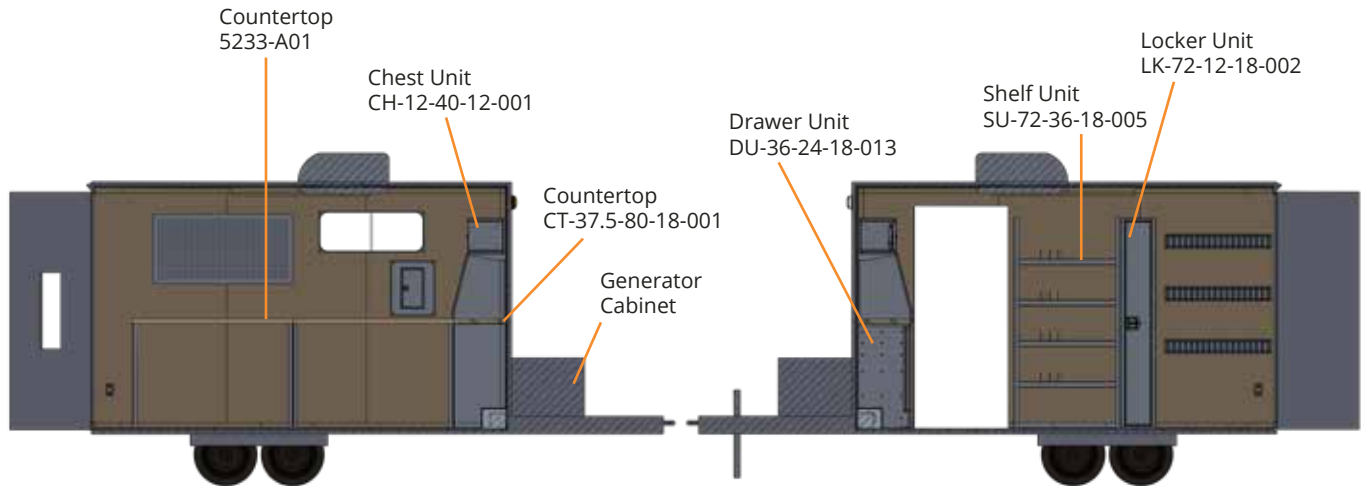

DRIVER SIDE

ITEM	PART #	QTY
Countertop	5233-A01	2
Chest Unit	CH-12-40-12-001	2
Countertop	CT-37.5-80-18-001	1

PASSENGER SIDE

ITEM	PART #	QTY
Drawer Unit	DU-36-24-18-013	1
Shelf Unit	SU-72-36-18-005	1
Locker Unit	LK-72-12-18-002	1

FEATURES:

EXTERIOR:

- 12'L x 7'H x 7'W dual axle enclosed trailer
- Flat front
- Out-board tires
- Pintle hitch
- Leveling jack
- Curb side door & splicer door on rear
- Rear barn doors
- Street side sliding window
- 6x scene lights
- 6x warning lights
- 2x exterior 110V plug on curb side
- Shore power on curb side
- 5000W Onan generator mounted on tongue
- 13,000 BTU air conditioner, roof mounted

INTERIOR:

- 2x 110V 48" LED lights
- 2x 110V plugs
- Espar heater
- Flooring, wall and ceiling panels
- Spray foam insulation for ceiling and walls



14' TRAILER

PACKAGE NUMBER: 3135



14' TRAILERS

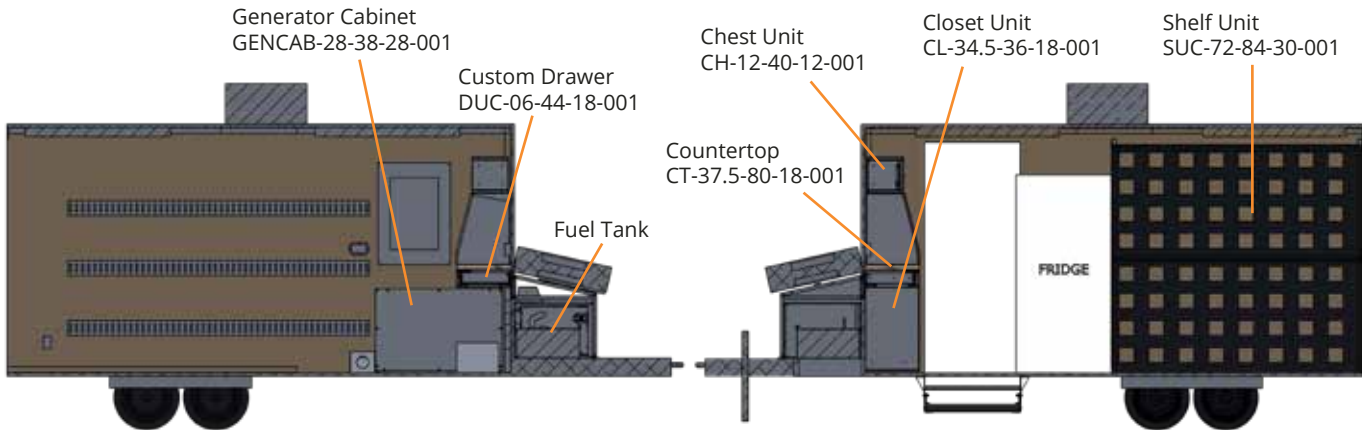

DRIVER SIDE

ITEM	PART #	QTY
Generator Cabinet	GENCAB-28-38-28-001	1
Custom Drawer	DUC-06-44-18-001	1

PASSENGER SIDE

ITEM	PART #	QTY
Countertop	CT-37.5-80-18-001	1
Chest Unit	CH-12-40-12-001	2
Closet Unit	CL-34.5-36-18-001	1
Shelf Unit	SUC-72-84-30-001	1

FEATURES:

EXTERIOR:

- 14'L x 7'H enclosed trailer
- Out-board tires
- Passenger side door with fold down step
- Rear ramp door
- 1 scene light on both sides and rear
- 1 exterior 110V plug on passenger side
- Fuel tank mounted on tongue with spare tire
- Full length awning on passenger side

INTERIOR:

- 4x scene lights
- 2x fluorescent scene lights
- 2x 110V plugs
- 1x battery
- Generator panel with transfer switch
- Flooring and walls included
- Spray foam insulation for ceiling and walls



14' TRAILER

14' TRAILERS

PACKAGE NUMBER: 4949

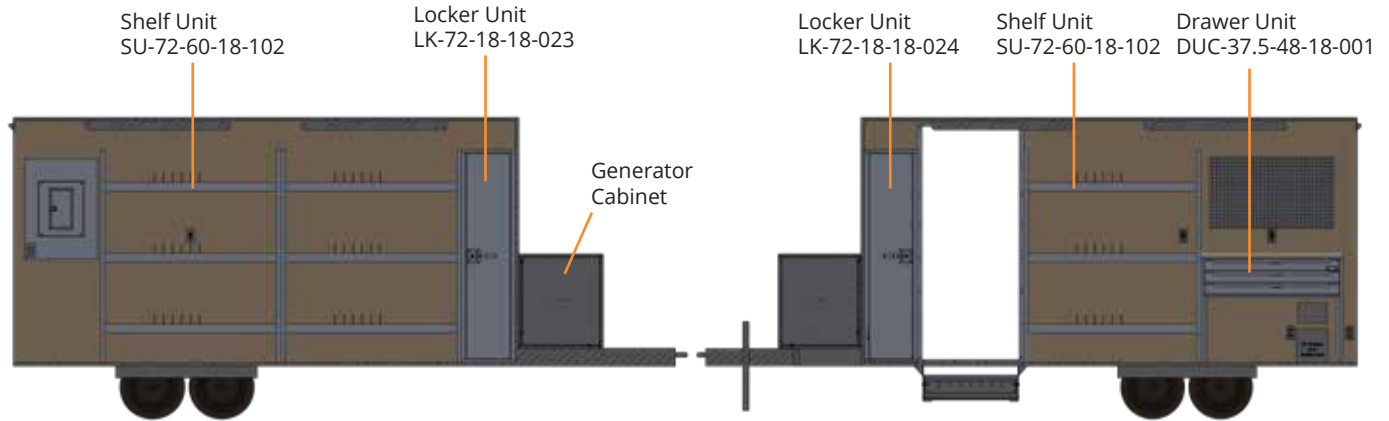

DRIVER SIDE

ITEM	PART #	QTY
Shelf Unit	SU-72-60-18-102	2
Locker Unit	LK-72-18-18-023	1

PASSENGER SIDE

ITEM	PART #	QTY
Locker Unit	LK-72-18-18-024	1
Shelf Unit	SU-72-60-18-102	1
Drawer Unit	DUC-37.5-48-18-001	1

FEATURES:

EXTERIOR:

- 14'L x 7'H x 7'W enclosed trailer
- Flat front
- 6000LB tandem spring axles w/ brakes & easy-lube
- 4x 15" radial tires w/ white rims
- 1x 15" radial spare tire w/ white rim
- 3" adjustable pintle coupler
- 5000LB a-frame jack stand w/ foot
- Double rear barn doors w/ camlock
- 32" passenger side door w/ camlock
- Honda EM6500S generator
- 3x LED lights

INTERIOR:

- 2x LED lights
- 5x 120V/15A plugs
- 1x 120V/30A shore power
- 8 circuit electrical panel
- 1/4" white plywood walls and ceiling
- Black hex pattern flooring
- Peg board on wall - 48"W x 24"H



14' TRAILER

PACKAGE NUMBER: 7926



14' TRAILERS

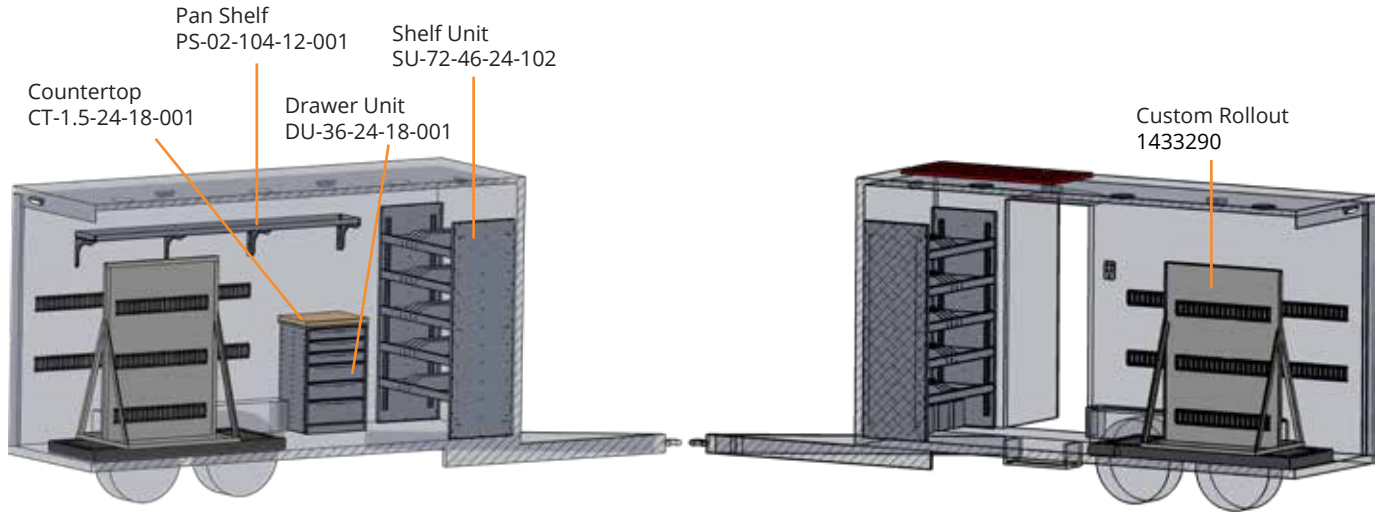

DRIVER SIDE

ITEM	PART #	QTY
Countertop	CT-1.5-24-18-001	1
Pan Shelf	PS-02-104-12-001	1
Drawer Unit	DU-36-24-18-001	1
Shelf Unit	SU-72-46-24-102	1

PASSENGER SIDE

ITEM	PART #	QTY
Custom Rollout	1433290	1

FEATURES:

EXTERIOR:

- 14'L x 8.5"W
- 7' interior height
- 60" tongue
- Steel frame, painted black
- Flat front, roof and floor
- Passenger side RV style drawer
- Rear barn doors with cam locks
- White screwless panels
- 8x 12V scene lights
- Solar panel

INTERIOR:

- 3/4" plywood flooring
- 3/8" plywood on walls with white lining
- 1/4" plywood on ceiling with white lining
- 4" trim
- 6x 12V interior LED dome lights
- Shore power
- 4x 7'L E-track
- 3x 12V battery and charger
- Electrical outlet



16' TRAILER

PACKAGE NUMBER: 5398



16' TRAILERS

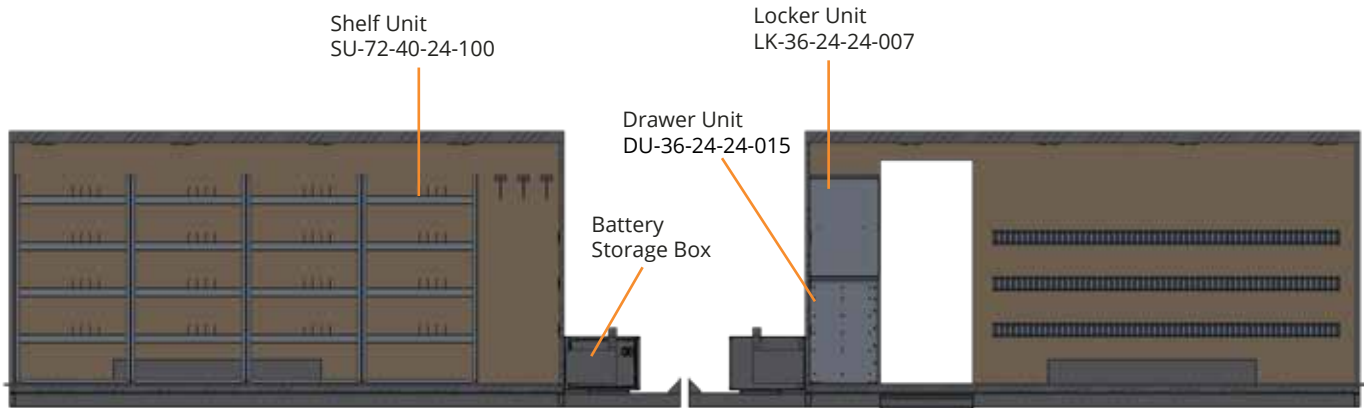

DRIVER SIDE

ITEM	PART #	QTY
Shelf Unit	SU-72-40-24-100	4

PASSENGER SIDE

ITEM	PART #	QTY
Drawer Unit	DU-36-24-24-015	1
Locker Unit	LK-36-24-24-007	1

FEATURES:

EXTERIOR:

- 16'L x 7'H enclosed trailer
- Galvanized steel frame
- Flat front
- Tandem 8000LB Dexter spring axles
- 4x radial tires
- 3" adjustable pintle coupler
- Rear ramp door w/ spring assist & camlock
- 34" side door w/ cam lock & flush lock
- 4x 12V scene lights
- 4x 12V amber flasher
- 14' manual awning on passenger side
- Galvanized steel frame trailer

INTERIOR:

- 8x 12V LED lights
- 1x 15A shore power plug
- 2x 6V batteries with 20A battery charger
- 1/4" white plywood walls and ceiling
- 3/4" plywood flooring
- E-tracks



16' TRAILER

PACKAGE NUMBER: 5121

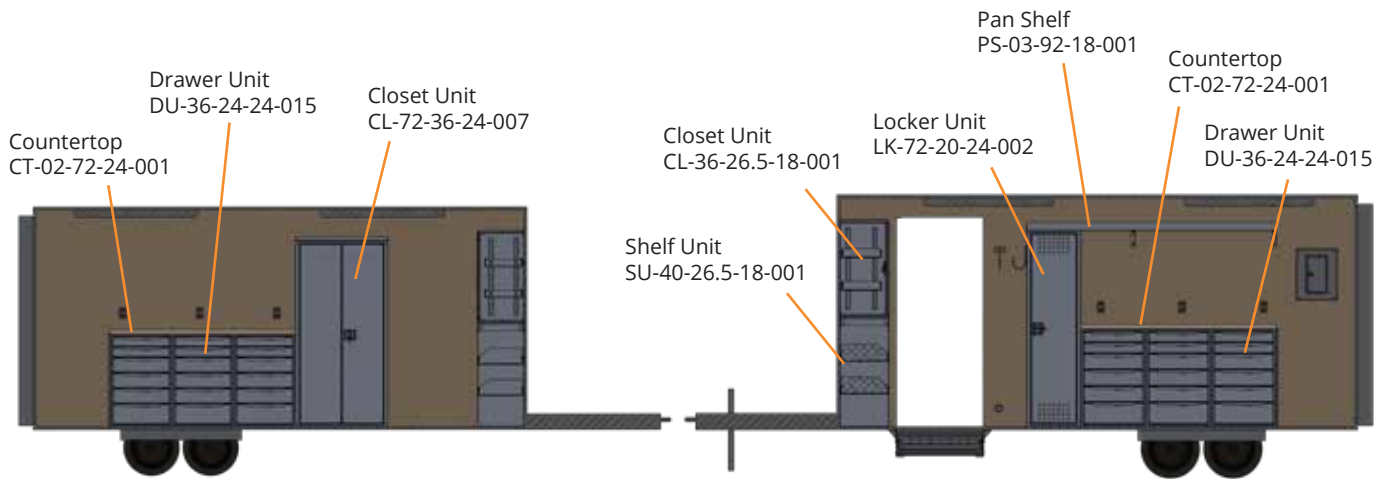

DRIVER SIDE

ITEM	PART #	QTY
Countertop	CT-02-72-24-001	1
Drawer Unit	DU-36-24-24-015	3
Closet Unit	CL-72-36-24-007	1

PASSENGER SIDE

ITEM	PART #	QTY
Shelf Unit	SU-40-26.5-18-001	3
Closet Unit	CL-36-26.5-18-001	3
Locker Unit	LK-72-20-24-002	1
Pan Shelf	PS-03-92-18-001	1
Countertop	CT-02-72-24-001	1
Drawer Unit	DU-36-24-24-015	3

FEATURES:

EXTERIOR:

- 16'L x 7"H x 7"W enclosed trailer
- Tandem 8000LB Dexter torsion axles
- 4x 17.5" radial tires (spare tire placed on a-frame)
- Pintle coupler
- Aluminum white exterior screwless panels
- Double rear barn doors w/ camlock
- 2x ladder racks

INTERIOR:

- 3/8" plywood lined walls and ceiling
- 3/4" plywood lined floor
- 2x 48" LED lights
- 6x interior outlets, over countertops
- 1x 30amp/8 circuit breaker load center
- 3x swivel hooks



16' TRAILER

PACKAGE NUMBER: 7040

16' TRAILERS

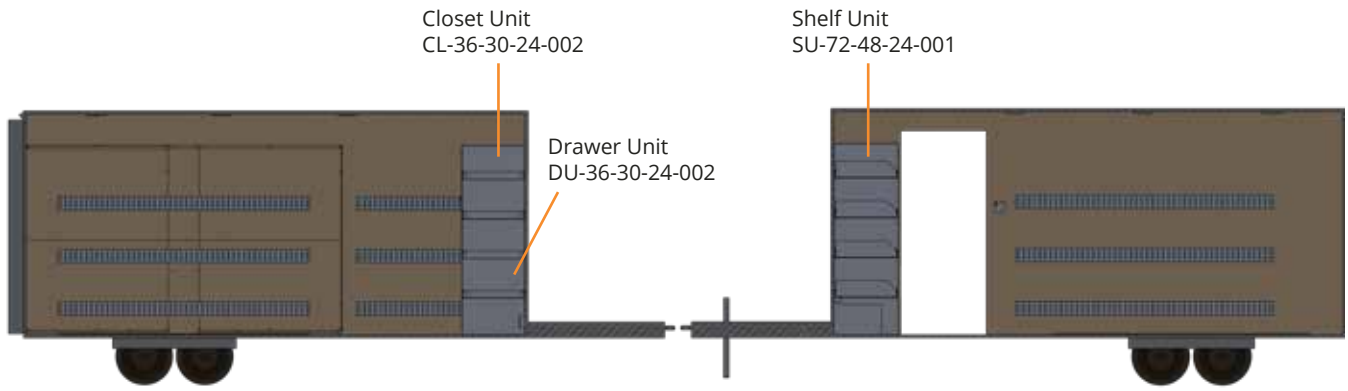

DRIVER SIDE

ITEM	PART #	QTY
Closet Unit	CL-36-30-24-002	1
Drawer Unit	DU-36-30-24-002	1

PASSENGER SIDE

ITEM	PART #	QTY
Shelf Unit	SU-72-48-24-001	1

FEATURES:

EXTERIOR:

- 16'L x 7"H enclosed trailer
- Flat front / roof
- Tandem 7000LB Dexter torsion axles
- 4x 17.5" radial tires (spare tire on a-frame)
- Pintle coupler
- Aluminum white exterior screwless panels
- Double rear barn doors w/ camlock
- 32" side door w/ camlock
- 3x 12V scene flood lights

INTERIOR:

- 6x 12V 8" LED dome lights
- 1x outlet
- 1x 15A shore power plug
- 1x 12V battery and charger
- 1x solar charger kit
- 3x 3' E-Tracks
- 8x 8' E-Tracks
- 1x 10'L x 30"W aluminum walk ramp



16' TRAILER

PACKAGE NUMBER: 7276

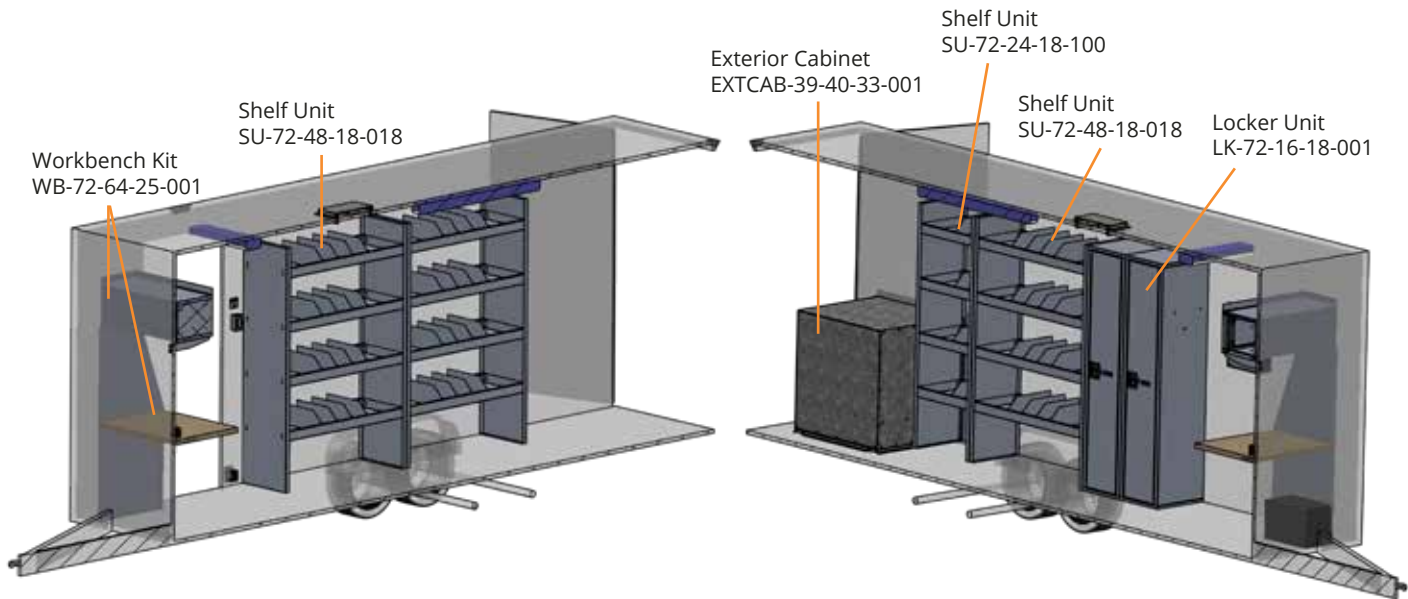

DRIVER SIDE

ITEM	PART #	QTY
Workbench Kit	WB-72-64-25-001	1
Shelf Unit	SU-72-48-18-018	2

PASSENGER SIDE

ITEM	PART #	QTY
Exterior Cabinet	EXTCAB-39-40-33-001	1
Shelf Unit	SU-72-24-18-100	1
Shelf Unit	SU-72-48-18-018	1
Locker Unit	LK-72-16-18-001	2

FEATURES:

EXTERIOR:

- 16'L x 7'H enclosed trailer
- Rear barn doors
- Passenger side door
- Sliding glass window
- Roof vent
- 2x LED scene light

INTERIOR:

- 2x 48" LED light bar
- 1x outlet with USB
- 60A service panel
- Shore power
- 12V battery with 20A charger
- White plywood walls and ceilings
- Black plywood flooring with hex pattern
- Spray foam insulation



18' TRAILER

PACKAGE NUMBER: 7302

18' TRAILERS

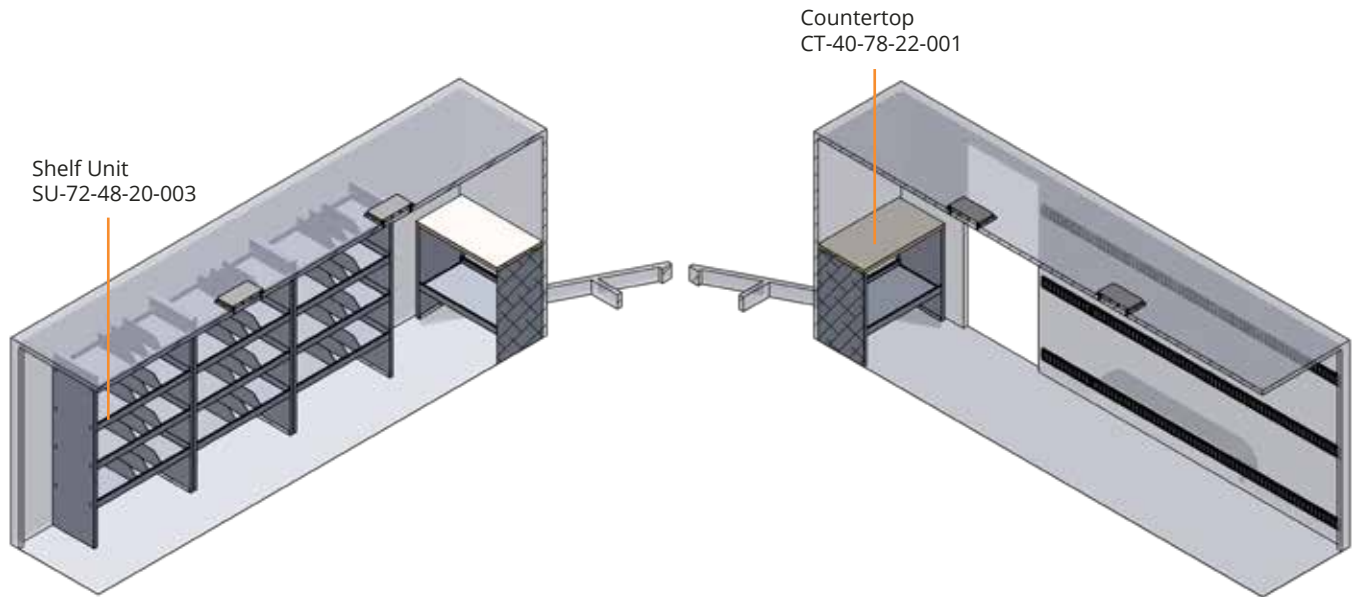

DRIVER SIDE

ITEM	PART #	QTY
Shelf Unit	SU-72-48-20-003	3

PASSENGER SIDE

ITEM	PART #	QTY
Countertop	CT-40-78-22-001	1

FEATURES:

EXTERIOR:

- 18'L x 7"H enclosed trailer w/ 60" tongue
- White exterior
- Adjustable pintle eye , 26" at highest position
- 8000LB tongue jack with sand pad
- 2x HD stabilizer jack at rear
- Painted steel chassis
- Tandem 5200LB spring axles
- Electric brakes
- Breakaway kit
- Rear ramp door w/ spring assist
- 2x manual roof vents

INTERIOR:

- 2x dome lights powered by 7-pin plug
- 3/4" flooring with bed liner + 12" up walls
- 1/2" thick white plywood walls
- E-Track on curbside wall
- 4x ratchet straps
- 24x E-Track J-hooks



20' TRAILER

PACKAGE NUMBER: 8192

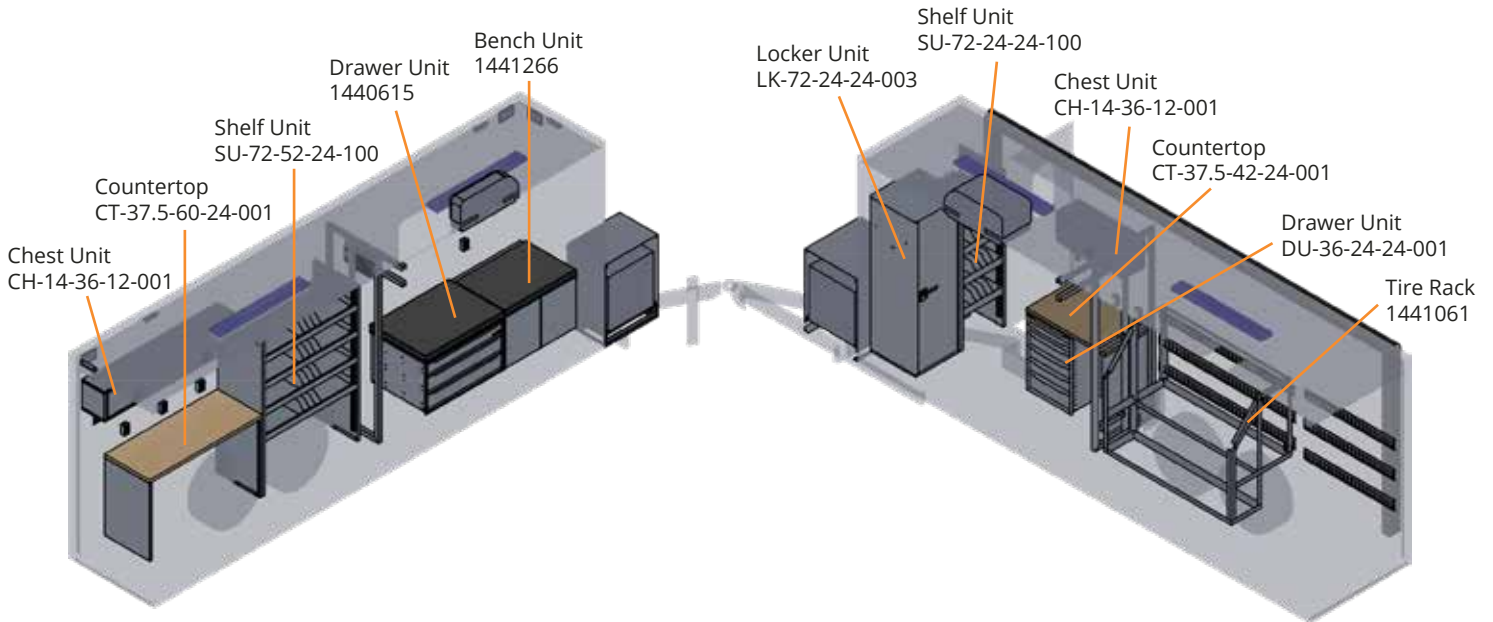

DRIVER SIDE

ITEM	PART #	QTY
Chest Unit	CH-14-36-12-001	2
Countertop	CT-37.5-60-24-001	1
Shelf Unit	SU-72-52-24-100	1
Drawer Unit	1440615	1
Bench Unit	1441266	1

PASSENGER SIDE

ITEM	PART #	QTY
Locker Unit	LK-72-24-24-003	1
Shelf Unit	SU-72-24-24-100	1
Chest Unit	CH-14-36-12-001	1
Countertop	CT-37.5-42-24-001	1
Drawer Unit	DU-36-24-24-001	1
Tire Rack	1441061	1

FEATURES:

EXTERIOR:

- Flat front/roof
- 8.5' interior height
- Tandem 7000LB Dexter torsion axles
- Electric brakes
- Aluminum white screwless panels
- Double rear barn doors with camlock
- Rear step across full width
- Passenger side RV style door
- Steel frame, painted black
- Adjustable pintle
- 8x scene lights and 6x amber lights
- Onan Generator in cabinet
- Breakaway kit
- 50A shore power plug
- 8000LB side wind drop leg jack
- Rear drop down jacks with locking pin
- Roof mounted air conditioner, 13500 BTU
- 18' manual awning on passenger side

INTERIOR:

- Spray foam insulated walls and ceiling, R7
- 1/2" plywood on walls and ceiling
- 3/4" floor decking
- 4x 48" LED lights



20' TRAILER

PACKAGE NUMBER: 3730

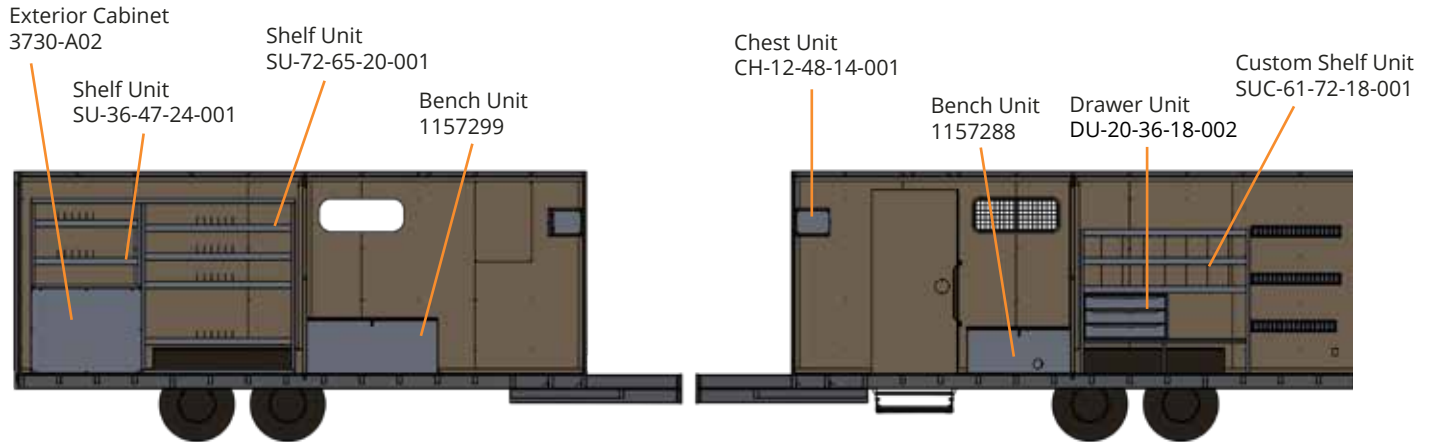

20' TRAILERS

DRIVER SIDE

ITEM	PART #	QTY
Exterior Cabinet	3730-A02	1
Shelf Unit	SU-36-47-24-001	1
Shelf Unit	SU-72-65-20-001	1
Bench Unit	1157299	1

PASSENGER SIDE

ITEM	PART #	QTY
Chest Unit	CH-12-48-14-001	2
Bench Unit	1157288	1
Drawer Unit	DU-20-36-18-002	1
Custom Shelf Unit	SUC-61-72-18-001	1

FEATURES:

EXTERIOR:

- 20'L enclosed trailer
- Curb side sliding window w/ protector
- Rear ramp door
- Curb side door
- 3x 12V scene flood lights

INTERIOR:

- 6x 12V 8" LED dome lights
- 1x outlet
- 1x 15A shore power plug
- 1x 12V battery and charger
- 1x solar charger kit
- 3x 3' E-Tracks
- 8x 8' E-Tracks
- 1x 10'L x 30"W aluminum walk ramp



20' TRAILER

PACKAGE NUMBER: 4795

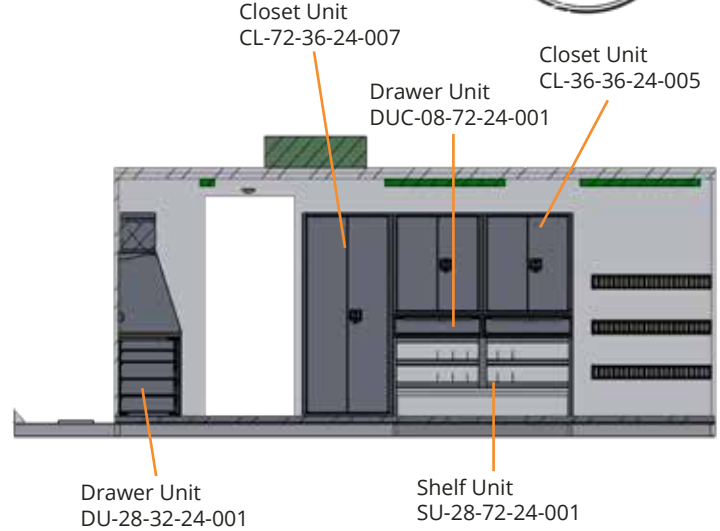
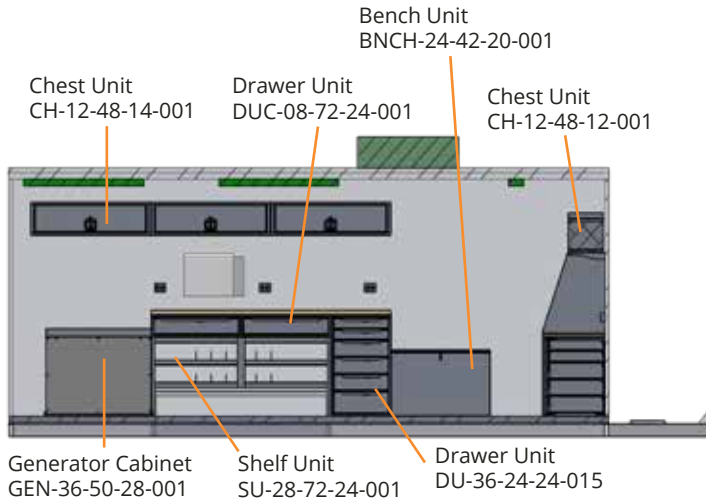

20' TRAILERS

DRIVER SIDE

ITEM	PART #	QTY
Chest Unit	CH-12-48-14-001	3
Generator Cabinet	GEN-36-50-28-001	1
Shelf Unit	SU-28-72-24-001	1
Drawer Unit	DUC-08-72-24-001	1
Drawer Unit	DU-36-24-24-015	1
Bench Unit	BNCH-24-42-20-001	1
Chest Unit	CH-12-48-12-001	1

PASSENGER SIDE

ITEM	PART #	QTY
Drawer Unit	DU-28-32-24-001	1
Closet Unit	CL-72-36-24-007	1
Drawer Unit	DUC-08-72-24-001	1
Closet Unit	CL-36-36-24-005	2
Shelf Unit	SU-28-72-24-001	1

FEATURES:

EXTERIOR:

- 20'L x 7'H enclosed trailer
- Flat roof / front
- Torsion 8000LB axles
- 4x 17.5" tires (spare tire included)
- 3" adjustable pintle coupler
- Rear ramp door w/ spring assist & camlock
- 34" side door w/ camlock
- Tinted slide windows with screen - driver side
- 14' awning on passenger side
- 4x scene lights
- 2x plugs

INTERIOR:

- Spray foam insulated walls and ceiling
- 1/4" white plywood on walls and ceiling
- 3/4" plywood flooring
- Onan 6000W diesel generator 120V, 50A
- Fuel tank with gauge under bench unit
- 3x 48" LED vaportight lights
- GFCI outlets over worktops
- Shore power
- Roof mount air conditioner & Espar heater



20' TRAILER

PACKAGE NUMBER: 4858

20' TRAILERS

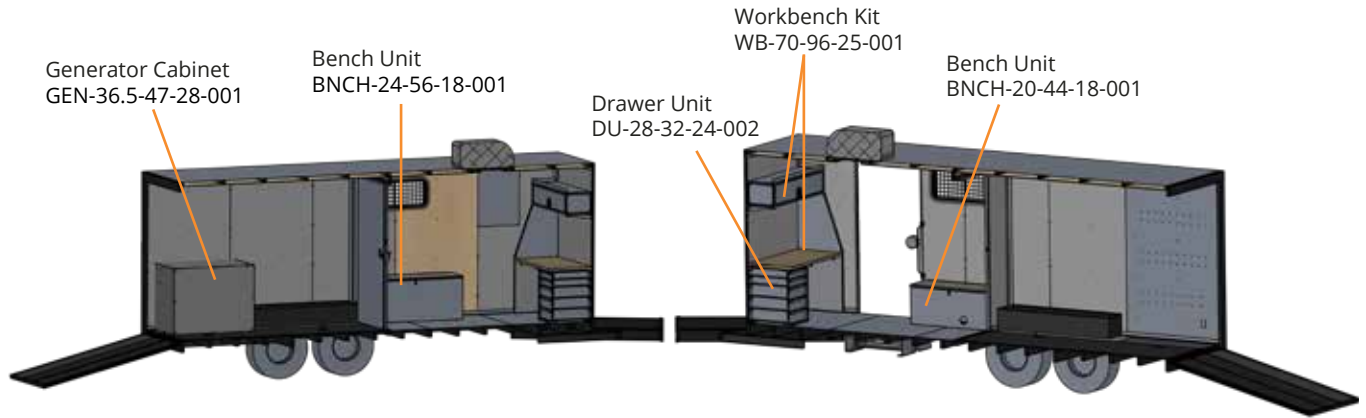

DRIVER SIDE

ITEM	PART #	QTY
Generator Cabinet	GEN-36.5-47-28-001	1
Bench Unit	BNCH-24-56-18-001	1

PASSENGER SIDE

ITEM	PART #	QTY
Drawer Unit	DU-28-32-24-002	1
Workbench Kit	WB-70-96-25-001	1
Bench Unit	BNCH-20-44-18-001	1

FEATURES:

EXTERIOR:

- 8x scene lights
- 4x amber flashers
- 16' awning
- 30A shore power plug
- Exterior plug
- 4x fuel cans with storage on A-frame
- 13,000 BTU air conditioner, roof mounted

INTERIOR:

- 3x swivel hooks
- 3x 3ft E-track
- 3x 5ft E-track
- Electrical panel
- 5x LED lights
- 12v battery and charger
- Electrical outlets
- Partition wall with sliding door
- Whiteboard
- 120v portable electric fan heater



20' TRAILER

PACKAGE NUMBER: 8251

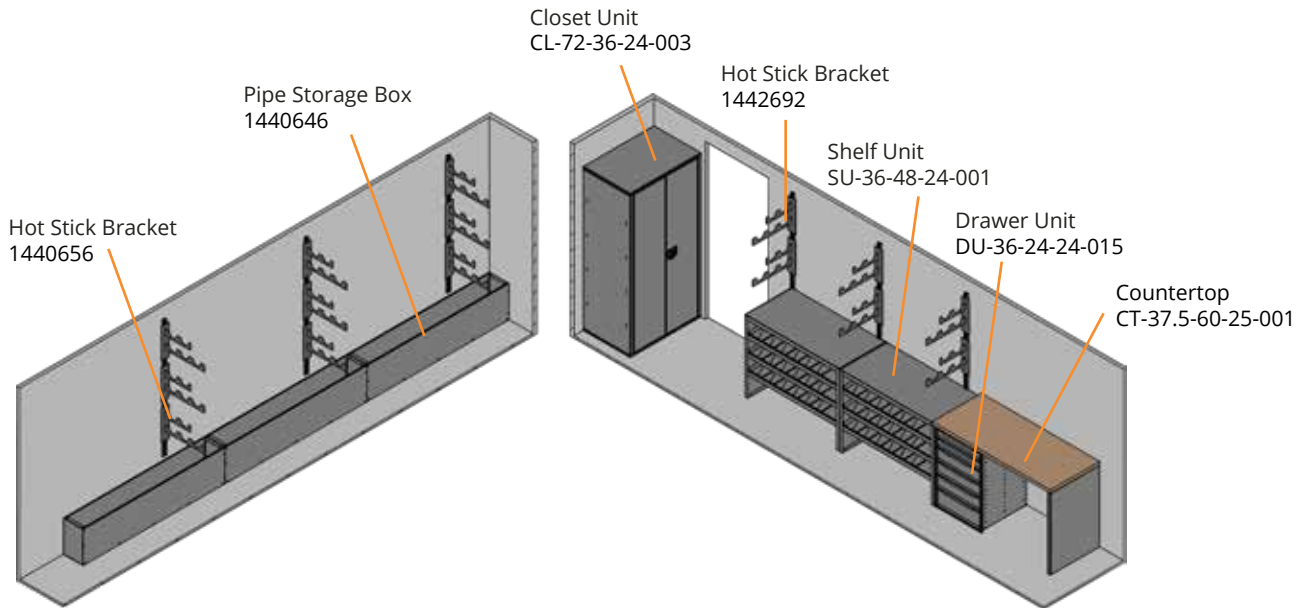

20' TRAILERS

DRIVER SIDE

ITEM	PART #	QTY
Hot Stick Bracket	1440656	3
Pipe Storage Box	1440646	3

PASSENGER SIDE

ITEM	PART #	QTY
Closet Unit	CL-72-36-24-003	1
Hot Stick Bracket	1442692	3
Shelf Unit	SU-36-48-24-001	2
Drawer Unit	DU-36-24-24-015	1
Countertop	CT-37.5-60-25-001	1

FEATURES:

This trailer was designed with only cabinets. Choose from the options listed below to add to the trailer.

- Shore power
- GFI Plugs
- 12V & 110V lighting



20' TRAILER

PACKAGE NUMBER: 6169

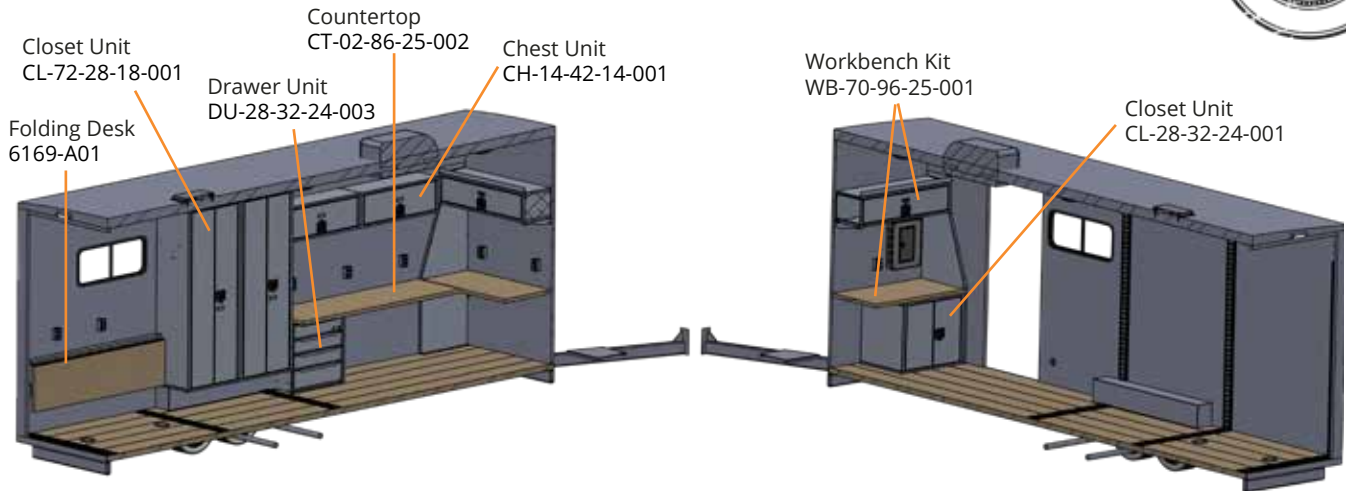

DRIVER SIDE

ITEM	PART #	QTY
Closet Unit	CL-72-28-18-001	2
Drawer Unit	DU-28-32-24-003	1
Countertop	CT-02-86-25-002	1
Chest Unit	CH-14-42-14-001	2

PASSENGER SIDE

ITEM	PART #	QTY
Workbench Kit	WB-70-96-25-001	1
Closet Unit	CL-28-32-24-001	1

FEATURES:

TRAILER:

- 20'L x 8.5"H enclosed trailer
- 7000LB tandem axles w/ spring torsion suspension
- 7000LB tongue jack
- Rear ramp door
- 32" RV style screen door
- 12V solarcharger for breakaway kit

EXTERIOR:

- Roof vent
- 2x LED scene lights over rear door
- 1x LED scene light over side door
- 2x outlets
- 13,000 BTU air conditioning, roof mounted

INTERIOR:

- 15,000 BTU air conditioner with heatstrip
- Recessed E-Track
- 4x recessed HD tie-down rings in floor
- 2x 12V LED dome lights
- 4x 48" LED light fixtures
- 8x outlets
- 100A service panel
- Shore power
- Folding desk



20' TRAILER

PACKAGE NUMBER: 7006



DRIVER SIDE

ITEM	PART #	QTY
Shelf Unit	SU-72-48-22-005	3
Shelf Unit	SU-72-48-24-007	1

PASSENGER SIDE

ITEM	PART #	QTY
Shelf Unit	SU-72-66-18-100	1
Drawer Unit	DU-36-36-24-020	1
Countertop	1018500	1
Generator Cabinet	7006-A01	1

FEATURES:

TRAILER:

- 20'L x 7"H enclosed trailer
- Extended tongue (60")
- 7000LB tandem torsion axles
- Painted steel frame
- 8000LB manual crank front jack
- 32" side man door
- Rear ramp door
- Cutout for generator cabinet

EXTERIOR:

- 18' awning
- 2x LED scene lights per side
- 2x LED scene lights at rear
- Weatherproof GFCI outlet
- 13,000 BTU air conditioner on roof
- Roof mounted ladder racks

INTERIOR:

- Generator panel - 30A/35CT, 120/240V
- Shore power plug - 30A/125V
- 15A outlet over workbench
- 15A outlet at bottom of 2 shelves
- 120V LED lighting
- Honda EU7000is



20' TRAILER

PACKAGE NUMBER: 6919

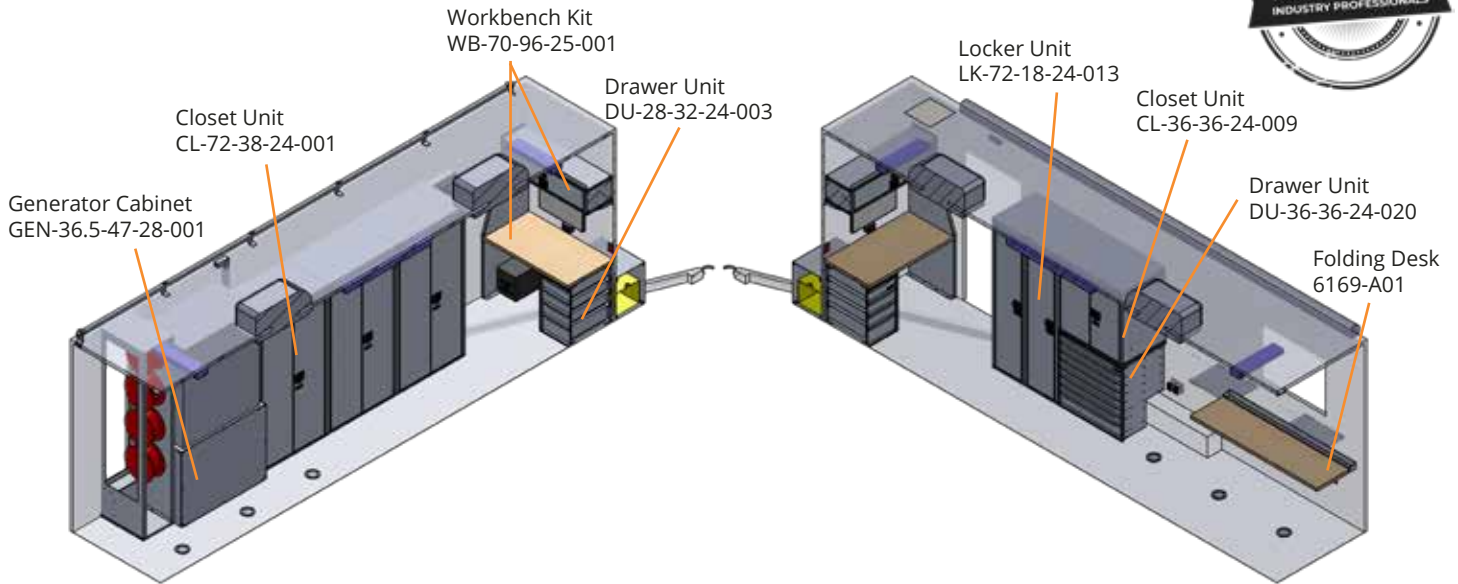

20' TRAILERS

DRIVER SIDE

ITEM	PART #	QTY
Generator Cabinet	GEN-36.5-47-28-001	1
Closet Unit	CL-72-38-24-001	3
Workbench Kit	WB-70-96-25-001	1
Drawer Unit	DU-28-32-24-003	1

PASSENGER SIDE

ITEM	PART #	QTY
Locker Unit	LK-72-18-24-013	1
Closet Unit	CL-36-36-24-009	1
Drawer Unit	DU-36-36-24-020	1
Folding Desk	6169-A01	1

FEATURES:

EXTERIOR:

- Galvanized steel chassis
- Tandem 8000LB Dexter axles (grease packed)
- Electric Brakes w/ solarcharger breakaway kit
- Hubodometer on LF hub
- 3" adjustable lunette eye
- 12,000LB Holland tongue jack
- 13,500 BTU air conditioner, roof mounted
- 18' canvas awning
- 2x 12V LED scene light
- Fold-down laptop tray
- Weatherproof outlet with USB
- Shore power plug - 30A/125V
- Cable pass through
- Exterior flip-up door
- Exterior cabinet
- Antenna rail assembly

INTERIOR:

- 12V battery and 20A charger
- Electrical panel - 100A / 8 circuit breakers
- 3x 110V vaportight LED light
- 2x 15A standard outlet
- NetShelter SX 24U enclosure
- 4x phone jack



24' TRAILER

PACKAGE NUMBER: 3724

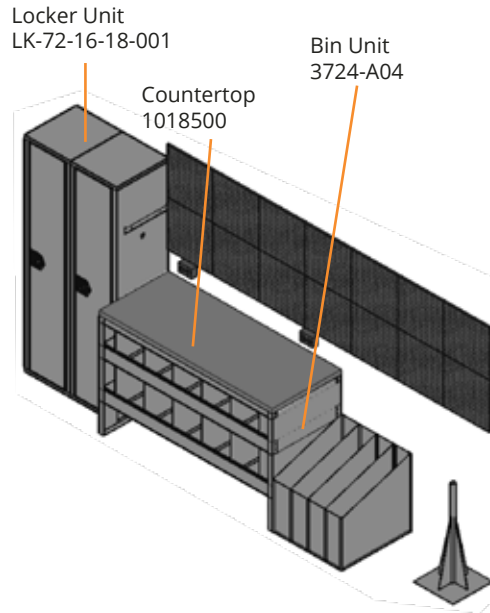
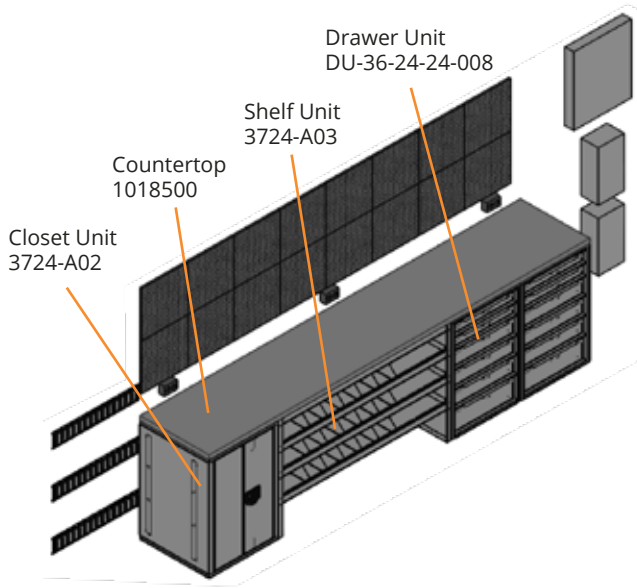

DRIVER SIDE

ITEM	PART #	QTY
Closet Unit	3724-A02	1
Countertop	1018500	1
Shelf Unit	3724-A03	1
Drawer Unit	DU-36-24-24-008	2

PASSENGER SIDE

ITEM	PART #	QTY
Locker Unit	LK-72-16-18-001	2
Countertop	1018500	1
Bin Unit	3724-A04	1

FEATURES:

INTERIOR:

- 12V LED scene light
- Peg board
- Cone holder
- Cover holder
- 3x steel E-Track
- 7x 120V outlet
- Load center
- 2x switch/disconnect



24' TRAILER

PACKAGE NUMBER: 5485

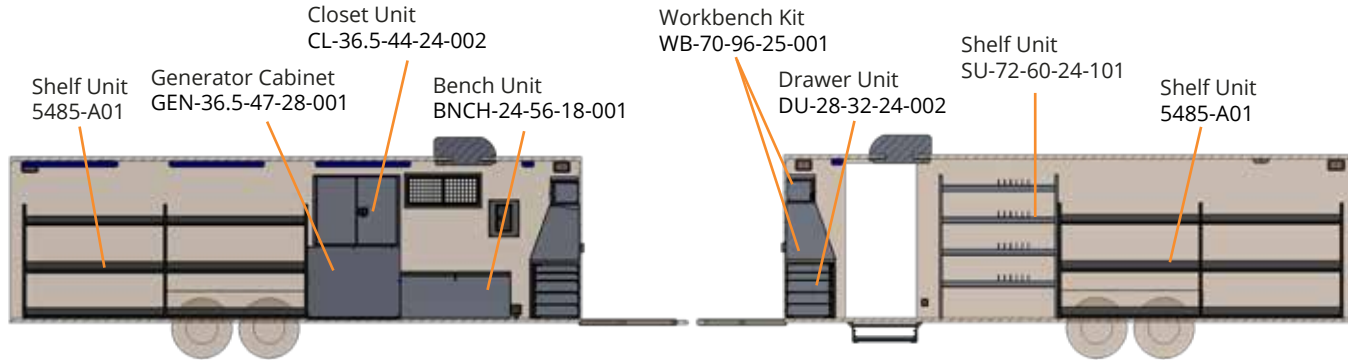

DRIVER SIDE

ITEM	PART #	QTY
Shelf Unit	5485-A01	1
Generator Cabinet	GEN-36.5-47-28-001	1
Closet Unit	CL-36.5-44-24-002	1
Bench Unit	BNCH-24-56-18-001	1

PASSENGER SIDE

ITEM	PART #	QTY
Workbench	WB-70-96-25-001	1
Drawer Unit	DU-28-32-24-002	1
Shelf Unit	SU-72-60-24-101	1
Shelf Unit	5485-A01	1

FEATURES:

EXTERIOR:

- 13,500 BTU air conditioner, roof mounted
- 2x LED lights
- 2x amber flashers
- 30A shore power plug

INTERIOR:

- Insulated walls and ceiling
- 1/4" white smooth plywood on walls and ceiling
- 12V battery and 20A charger
- Bench seat with fuel tank and gauge inside
- 3/4" floor, black plywood with hex pattern
- 4x 48" LED lights
- 1x 30A/110V outlets
- 7.5KW 120V Onan generator with fuel
- Espar heater



25' TRAILER

PACKAGE NUMBER: 7064

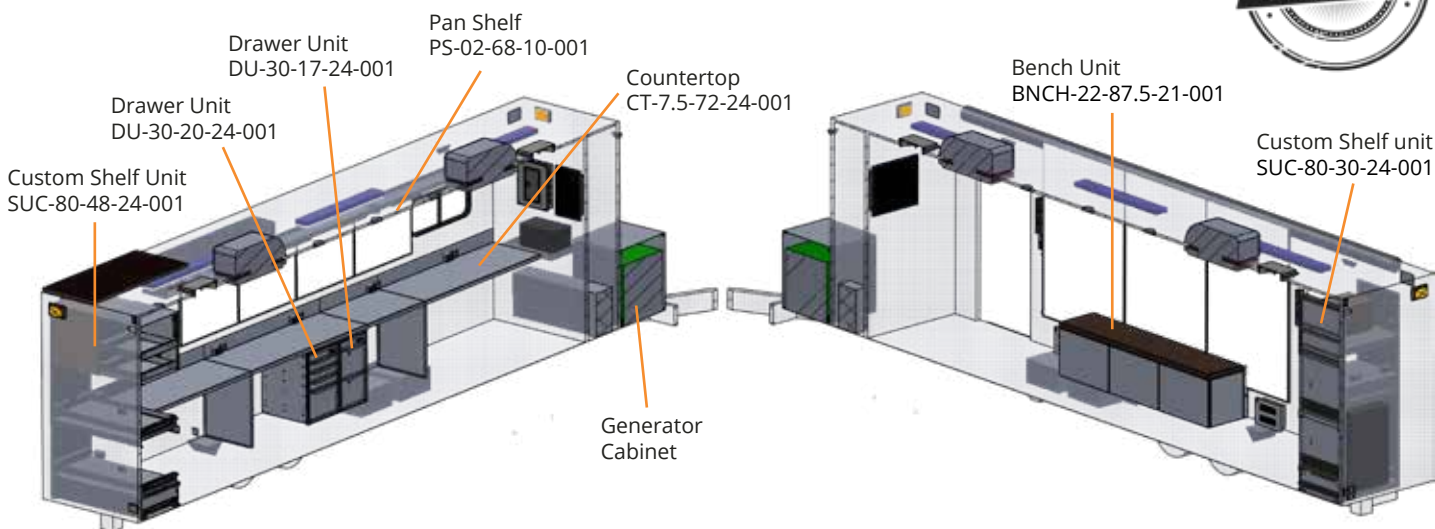

DRIVER SIDE

ITEM	PART #	QTY
Custom Shelf Unit	SUC-80-48-24-001	1
Drawer Unit	DU-30-20-24-001	1
Drawer Unit	DU-30-17-24-001	1
Countertop	CT-7.5-72-24-001	2
Pan Shelf	PS-02-68-10-001	2

PASSENGER SIDE

ITEM	PART #	QTY
Bench Unit	BNCH-22-87.5-21-001	1
Custom Shelf Unit	SUC-80-30-24-001	1

FEATURES:

EXTERIOR:

- Tandem 8000LBS Dexter Axels
- Aluminum chassis
- Adjustable pintle
- Bolted - electric 12,000LBS front jack
- 4x HD electric outriggers
- 2x curbside man doors
- Fold-in steps
- Removable entry handles
- 2x street side windows
- Standard DOT lighting & scene lighting
- Exterior outlets
- 2x 12V roof vents
- 10KW Onan generator

INTERIOR:

- 2x 13,000 BTU air conditioners w/ heatstrip
- 2x forced air heaters
- 49" LED TV
- Outlets w/ USB ports above desk
- 12U tripplite rack
- LED interior lighting
- Magnetic full height whiteboards
- 50A shore power & outlet
- 35 gallon fuel tank



25' TRAILERS

28' TRAILER

PACKAGE NUMBER: 6372

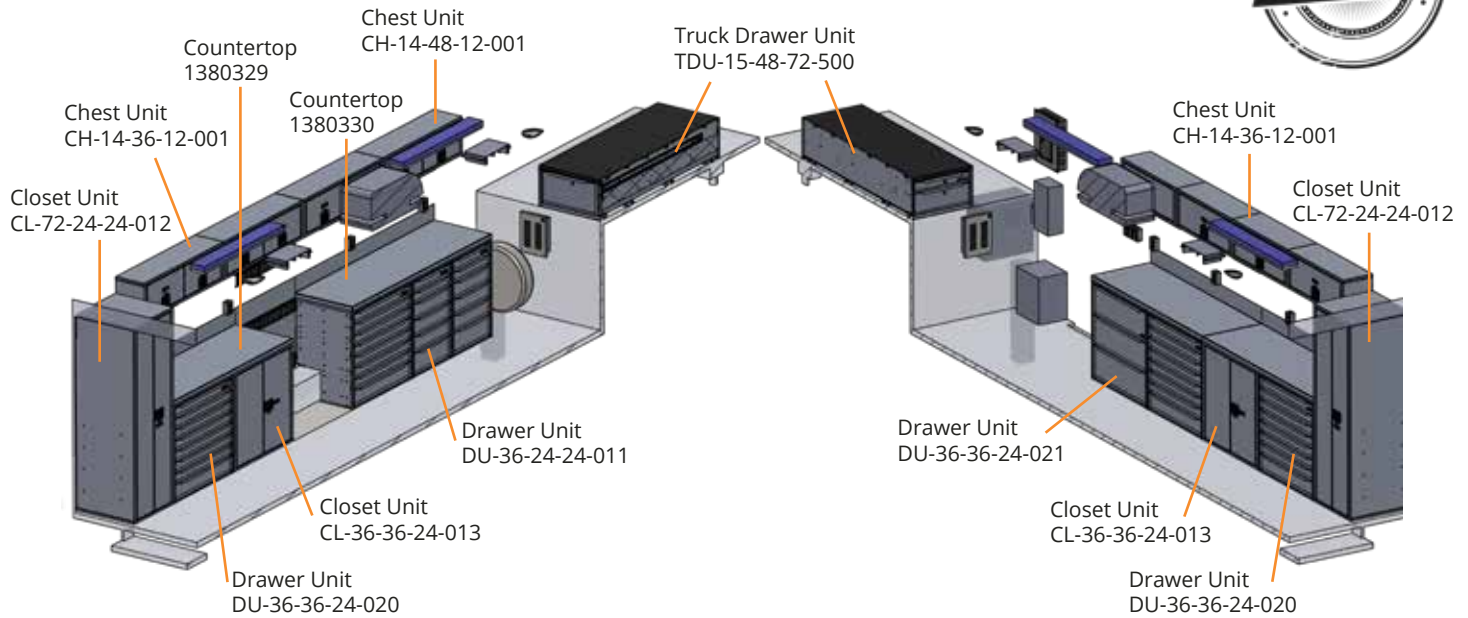

DRIVER SIDE

ITEM	PART #	QTY
Closet Unit	CL-72-24-24-012	1
Chest Unit	CH-14-36-12-001	4
Countertop	1380329	1
Countertop	1380330	1
Chest Unit	CH-14-48-12-001	4
Drawer Unit	DU-36-36-24-020	2
Closet Unit	CL-36-36-24-013	1
Drawer Unit	DU-36-24-24-011	2

PASSENGER SIDE

ITEM	PART #	QTY
Truck Drawer Unit	TDU-15-48-72-500	1
Chest Unit	CH-14-36-12-001	1
Closet Unit	CL-72-24-24-012	1
Drawer Unit	DU-36-36-24-021	1
Closet Unit	CL-36-36-24-013	1
Drawer Unit	DU-36-36-24-020	2

FEATURES:

EXTERIOR:

- LED DOT approved lighting
- 7-pin plug with junction box
- Breakaway kit with battery diode
- Aluminum cover under gooseneck
- Exterior outlet
- 12V scene light
- 12,000 BTU air conditioning, roof mounted

INTERIOR:

- 4x 48" LED light fixtures
- 60A load panel
- 100A shore power
- 60A switch/disconnect
- Isolating transformer
- 2x 240V heaters
- AC/DC converter
- 7x outlets, 1x with USB
- 2x 12V dome lights
- 10x E-Track hooks



28' TRAILERS

28' TRAILER

PACKAGE NUMBER: 7295

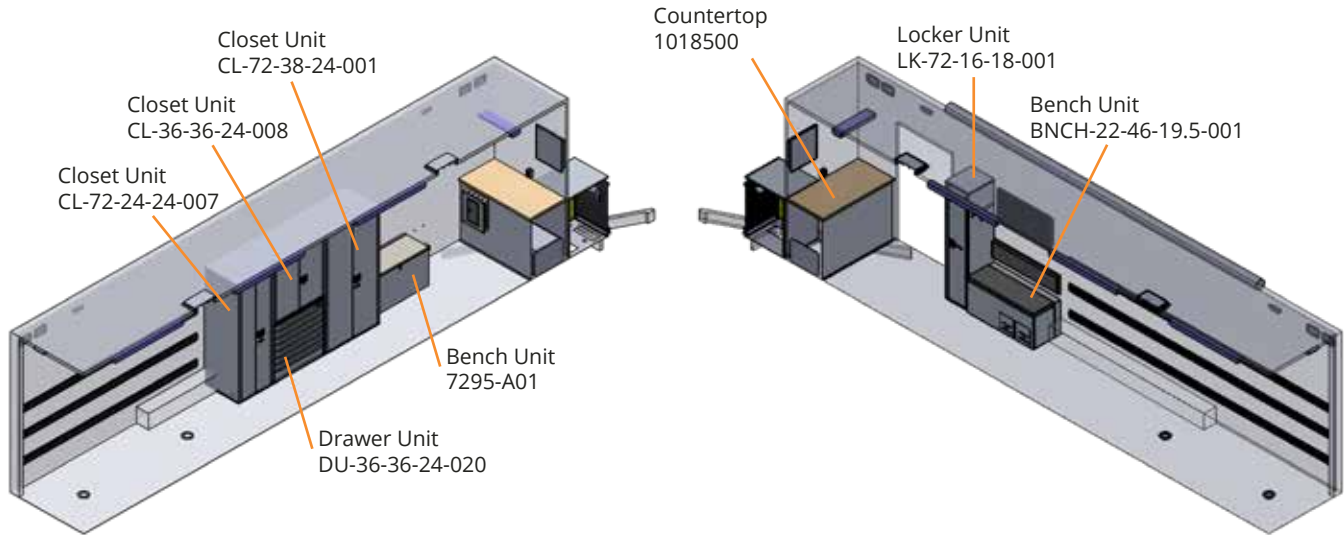

DRIVER SIDE

ITEM	PART #	QTY
Closet Unit	CL-72-24-24-007	1
Closet Unit	CL-36-36-24-008	1
Closet Unit	CL-72-38-24-001	1
Drawer Unit	DU-36-36-24-020	1
Bench Unit	7295-A01	1

PASSENGER SIDE

ITEM	PART #	QTY
Countertop	1018500	1
Locker Unit	LK-72-16-18-001	1
Bench Unit	BNCH-22-46-19.5-001	1

FEATURES:

EXTERIOR:

- Pass through compartment at front
- Breakaway kit
- 2x scene lighting per side
- 2x amber flashers per side
- 2x white flashers per side
- 18' manual crank awning
- 2x manual roof vents

INTERIOR:

- Dual 6V batteries and charger
- 50A shore power
- 4x 6000HD recessed d-rings
- 5LB fire extinguisher
- 7.5KW Onan generator
- 18 gal. diesel fuel tank
- 50 gal. water tank
- Breaker panel, 8CT, 80A, 120/140V
- 9x E-Track
- 3/4" black plywood flooring with hex pattern
- 1/4" white plywood walls and ceiling



28' TRAILER

PACKAGE NUMBER: 7471

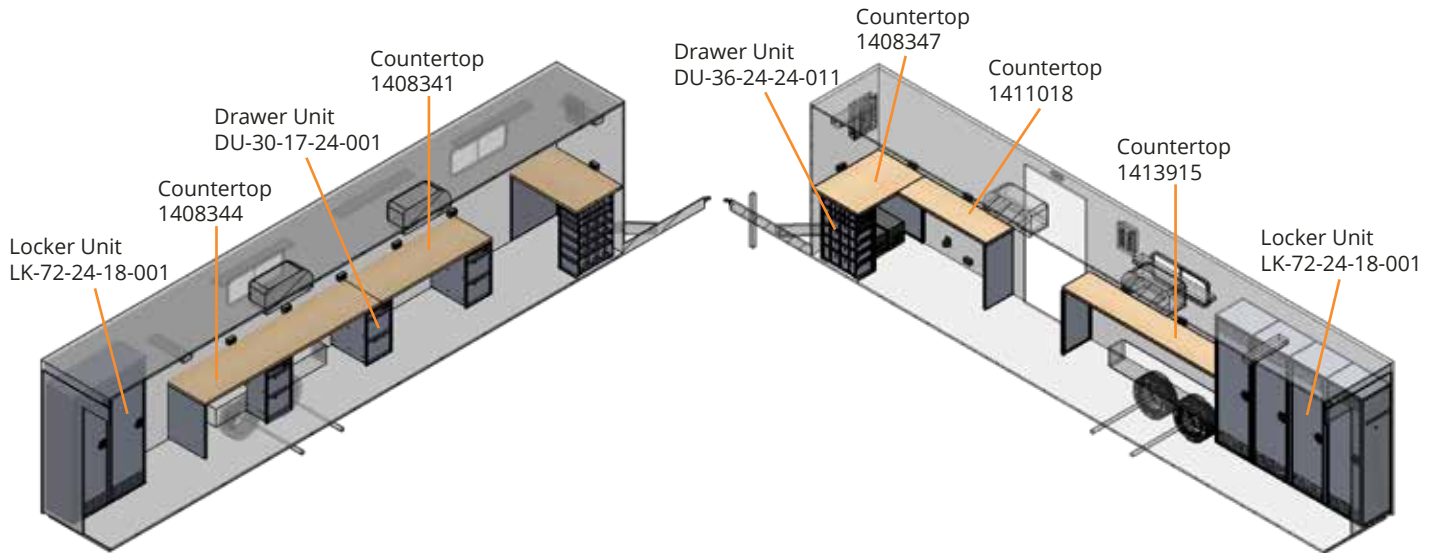

DRIVER SIDE

ITEM	PART #	QTY
Locker Unit	LK-72-24-18-001	2
Countertop	1408344	1
Drawer Unit	DU-30-17-24-001	3
Countertop	1408341	1

PASSENGER SIDE

ITEM	PART #	QTY
Drawer Unit	DU-36-24-24-011	1
Countertop	1408347	1
Countertop	1411018	1
Countertop	1413915	1
Locker Unit	LK-72-24-18-001	4

FEATURES:

EXTERIOR:

- 28'L x 7'H enclosed trailer
- Tandem 8000LB torsion axles
- 36"W rear man door
- 40"W side man door
- Adjustable pintle coupler
- 8000LB tongue jack
- Flat roof / front painted steel frame
- 2x 13,000 BTU A/C units with heatstrip
- Scene lighting over each door
- 2x weatherproof 15A, 125V GFCI outlets
- 1x shore power plug, 125/250V, 50A

INTERIOR:

- 1/4" white plywood walls
- 3/4" black plywood flooring with hex pattern
- 2x forced air wall heaters
- 14x 14A, 125V outlets
- Breaker panel, 32CT, 100A, 120/240V
- 2x 6V batteries and 20A charger
- 6x 110V LED vaportight lights



30' TRAILER

PACKAGE NUMBER: 4490

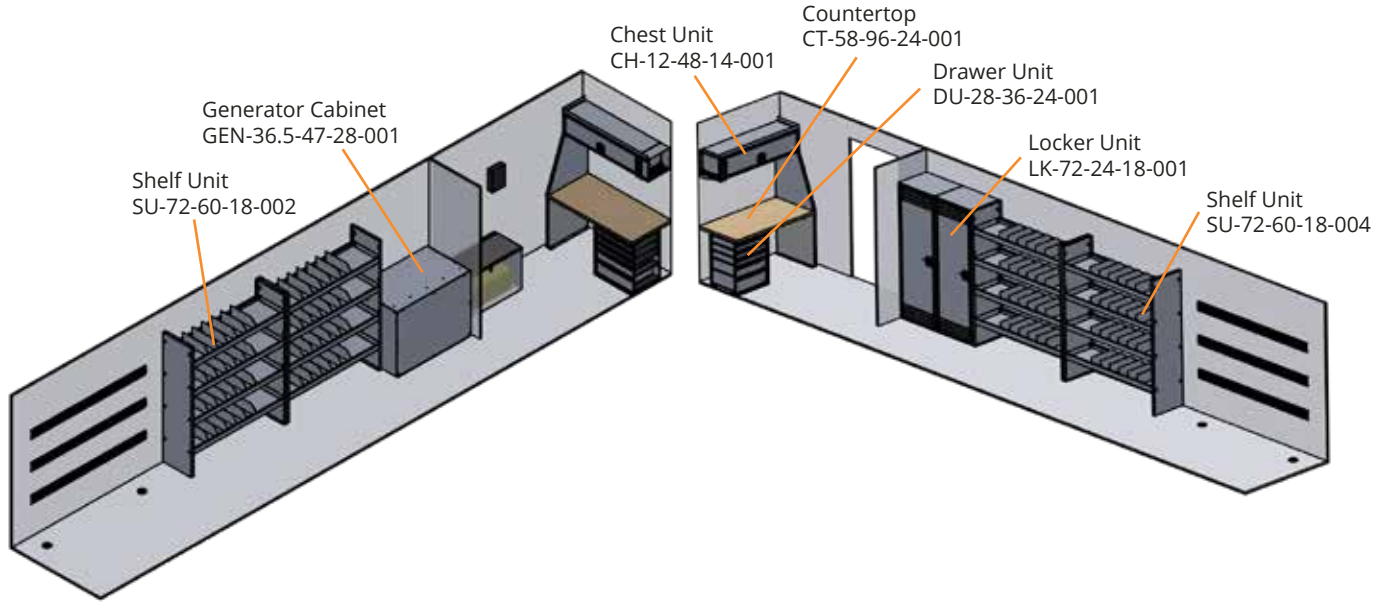

DRIVER SIDE

ITEM	PART #	QTY
Shelf Unit	SU-72-60-18-002	2
Generator Cabinet	GEN-36.5-47-28-001	1

PASSENGER SIDE

ITEM	PART #	QTY
Chest Unit	CH-12-48-14-001	2
Countertop	CT-58-96-24-001	1
Drawer Unit	DU-28-36-24-001	1
Locker Unit	LK-72-24-18-001	2
Shelf Unit	SU-72-60-18-004	2

FEATURES:

EXTERIOR:

- 30"L x 7"H enclosed trailer
- Rear ramp door
- 2x plugs
- 6x scene lights
- Roof mounted air conditioner

INTERIOR:

- Shore power
- 4x GFCI outlets
- Electrical panel
- Onan 7500W generator with 20 gal. fuel tank
- Espar D4 heater
- 4x tie-downs
- 6x 6' E-Track



30' TRAILERS

30' TRAILER

PACKAGE NUMBER: 4858

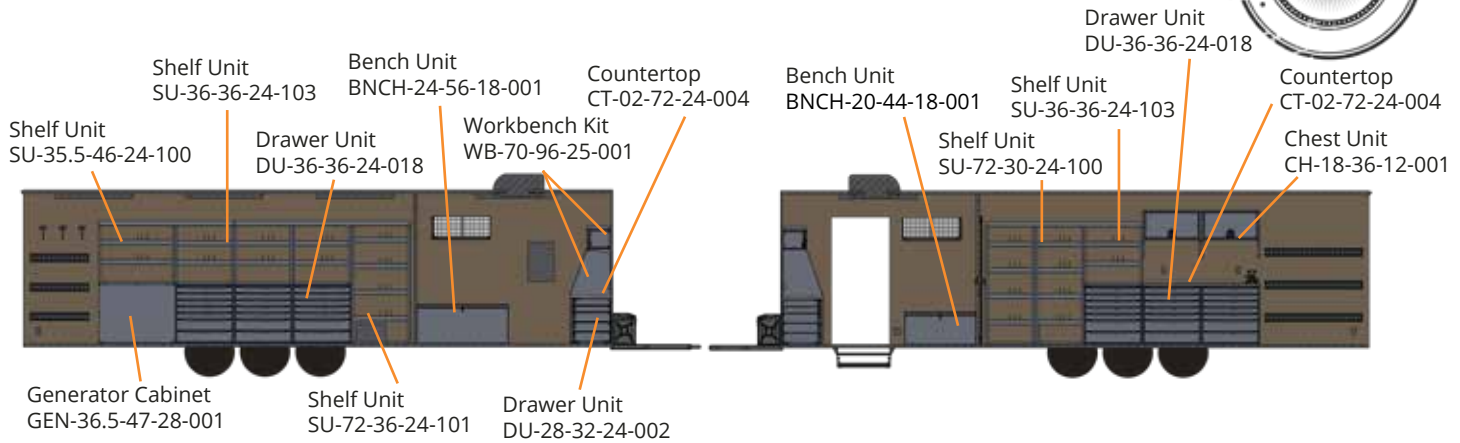

DRIVER SIDE

ITEM	PART #	QTY
Shelf Unit	SU-35.5-46-24-100	1
Shelf Unit	SU-36-36-24-103	3
Drawer Unit	DU-36-36-24-018	3
Bench Unit	BNCH-24-56-18-001	1
Workbench Kit	WB-70-96-25-001	2
Countertop	CT-02-72-24-004	1
Generator Cabinet	GEN-36.5-47-28-001	1
Shelf Unit	SU-72-36-24-101	1
Drawer Unit	DU-28-32-24-002	1

PASSENGER SIDE

ITEM	PART #	QTY
Bench Unit	BNCH-20-44-18-001	1
Shelf Unit	SU-72-30-24-100	2
Shelf Unit	SU-36-36-24-103	1
Drawer Unit	DU-36-36-24-018	3
Countertop	CT-02-72-24-004	1
Chest Unit	CH-18-36-12-001	2

FEATURES:

EXTERIOR:

- 2x scene lights on rear
- 3x scene lights per side
- 2x amber flashers per side
- 13,000 BTU air conditioner, roof mounted
- 30A shore power plug
- Exterior plug
- 4x fuel cans with storage on A-frame
- 16' awning

INTERIOR:

- 120V electric fan heater
- Heavy-duty armor mat
- 3x 5' E-Track
- 3x 3' E-Track
- Workbench vise
- Partition wall with sliding door
- 6x outlets
- Electrical panel
- 12V battery and charger
- 5x LED lights
- 3x swivel hooks
- Onan 7.5KW 120V generator
- Fuel tank with fuel gauge

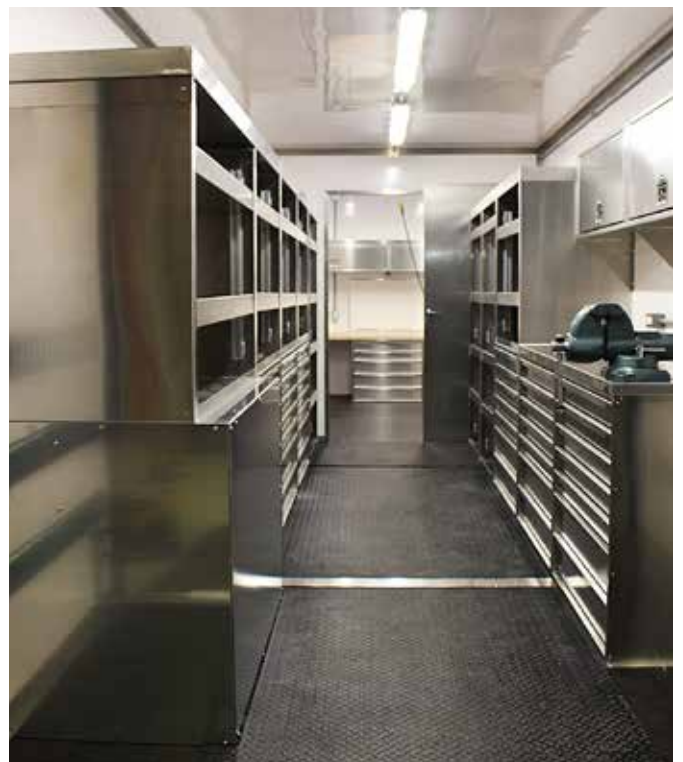

30' TRAILERS

30' TRAILER

PACKAGE NUMBER: 5747

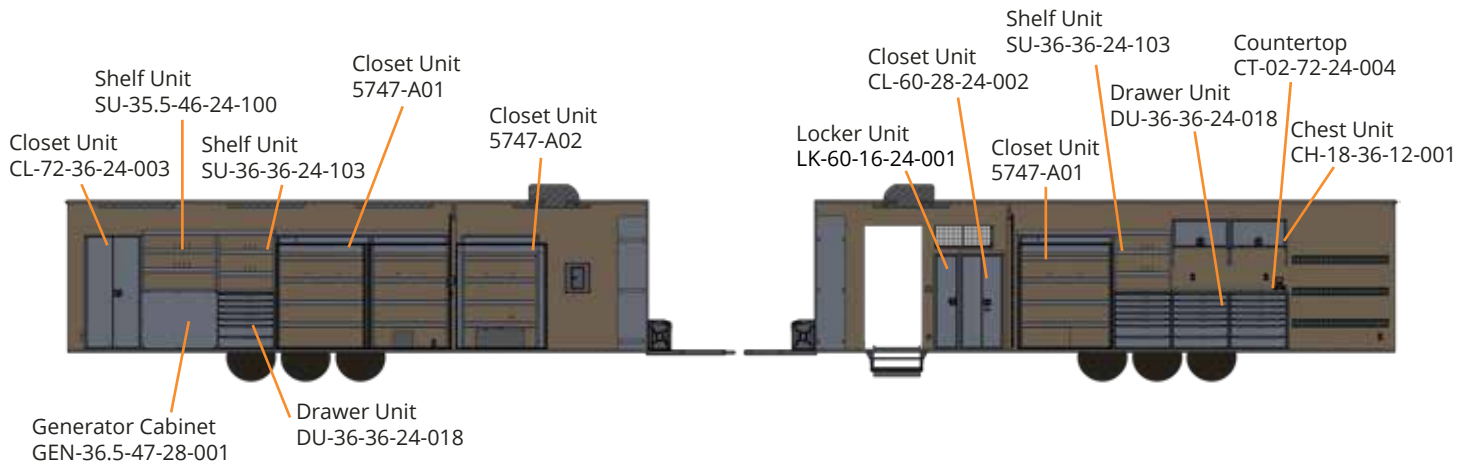

DRIVER SIDE

ITEM	PART #	QTY
Closet Unit	CL-72-36-24-003	1
Shelf Unit	SU-35.5-46-24-100	1
Shelf Unit	SU-36-36-24-103	1
Closet Unit	5747-A01	1
Closet Unit	5747-A02	2
Generator Cabinet	GEN-36.5-47-28-001	1
Drawer Unit	DU-36-36-24-018	1

PASSENGER SIDE

ITEM	PART #	QTY
Locker Unit	LK-60-16-24-001	1
Closet Unit	CL-60-28-24-002	1
Closet Unit	5747-A01	1
Shelf unit	SU-36-36-24-103	1
Drawer Unit	DU-36-36-24-018	3
Countertop	CT-02-72-24-004	1
Chest Unit	CH-18-36-12-001	2

FEATURES:

EXTERIOR:

- 30' enclosed trailer
- Rear ramp door
- 2x scene lights on rear
- 3x scene lights per side
- 2x amber flashers per side
- 13,000 BTU air conditioner, roof mounted
- 30A shore power plug
- Exterior plug
- 4x fuel cans with storage on A-frame
- 16' awning

INTERIOR:

- Adjustable tire rack
- 3x 5' E-Track
- Workbench vise
- 5x outlets
- Electrical panel
- 12V battery and charger
- 5x LED lights
- Partition wall with sliding door
- Fuel tank with fuel gauge inside
- 5x recessed D-rings in floor



30' TRAILERS

30' TRAILER

PACKAGE NUMBER: 7936

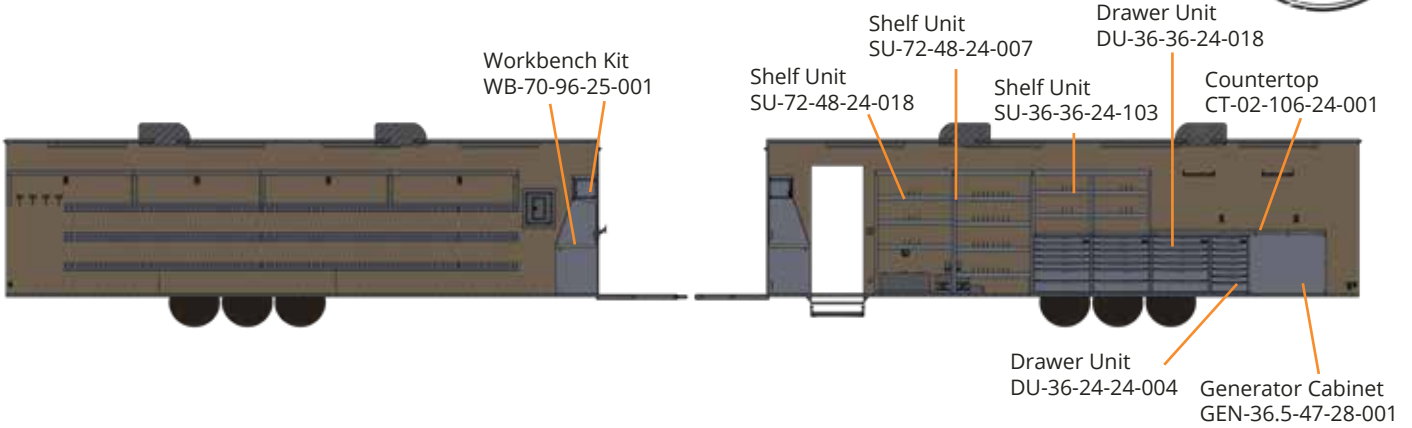

DRIVER SIDE

ITEM	PART #	QTY
Workbench Kit	WB-70-96-25-001	1

PASSENGER SIDE

ITEM	PART #	QTY
Shelf Unit	SU-72-48-24-018	1
Shelf Unit	SU-72-48-24-007	1
Shelf Unit	SU-36-36-24-103	2
Drawer Unit	DU-36-36-24-018	3
Countertop	CT-02-106-24-001	1
Drawer Unit	DU-36-24-24-004	1
Generator Cabinet	GEN-36.5-47-28-001	1

FEATURES:

EXTERIOR:

- 7-pin plug
- Breakaway kit
- 2x 13,000 BTU air conditioner, roof mounted
- 4x amber flashers
- 10x scene perimeter enhancement lights
- 4x weatherproof outlets

INTERIOR:

- 1x diesel tank for generator
- 7.5KW Onan quiet diesel generator
- 8x LED lights
- 30A shore power plug
- 10x outlets, 15A / 125V
- 2x 6V batteries and 1x 20A charger
- D4 diesel fired Espar heater
- E-Track on driver side wall
- Heavy rubber mat
- Spare tire holder
- 2' x 3' whiteboard
- 2x 18" LED lights over countertop
- 1/4" white plywood walls
- 3/4" black plywood flooring with hex pattern
- Spray foam insulation on walls & ceiling



30' TRAILERS

44' TRAILER

PACKAGE NUMBER: 6989

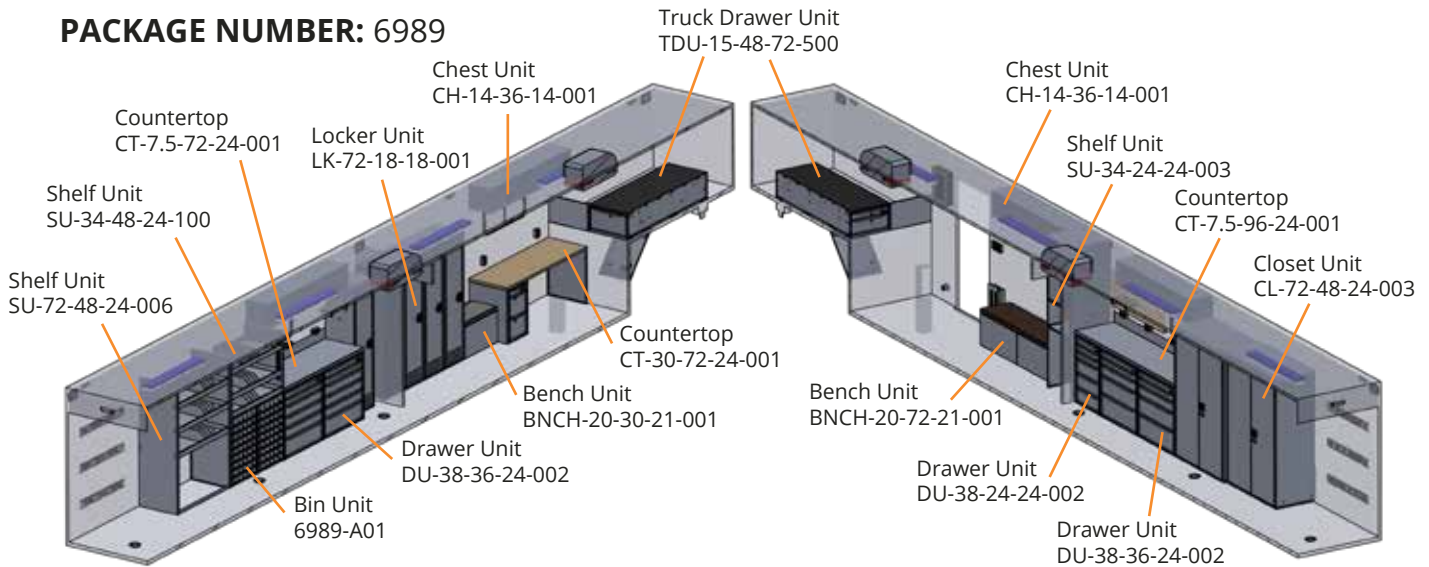

DRIVER SIDE

ITEM	PART #	QTY
Shelf Unit	SU-72-48-24-006	1
Shelf Unit	SU-34-48-24-100	1
Countertop	CT-7.5-72-24-001	1
Locker Unit	LK-72-18-18-001	5
Chest Unit	CH-14-36-14-001	2
Truck Drawer	TDU-15-48-72-500	1
Bin Unit	6989-A01	1
Drawer Unit	DU-38-36-24-002	1
Bench Unit	BNCH-20-30-21-001	1
Countertop	CT-30-72-24-001	1

PASSENGER SIDE

ITEM	PART #	QTY
Chest Unit	CH-14-36-14-001	4
Shelf Unit	SU-34-24-24-003	1
Countertop	CT-7.5-96-24-001	1
Closet Unit	CL-72-48-24-003	2
Drawer Unit	DU-38-36-24-002	2
Drawer Unit	DU-38-24-24-002	1
Bench Unit	BNCH-20-72-21-001	2

FEATURES:

EXTERIOR:

- 44'L x 7'H gooseneck trailer w/ 8000LB triaxle
- Electric brakes
- Power front jacks and 2x HD rear jacks
- Rear ramp door and side man door
- 2x air conditioners with heatstrips
- Outlet by side door
- 4x scene lights per side, 2x at rear
- 3x amber flashers per side

INTERIOR:

- Wall heater
- 100A shore power
- 7x standard 15A outlets
- 2x outlets with USB charger
- Partition wall with pass through
- 1/4" white plywood walls
- 3/4" black plywood flooring with hex pattern
- 6x E-Track
- 6x tie-down rings, 6000LBS capacity
- Spray foam insulation in walls and ceiling
- 8x 110V vaportight LED lights



44' TRAILERS

48' TRAILER

PACKAGE NUMBER: 6170

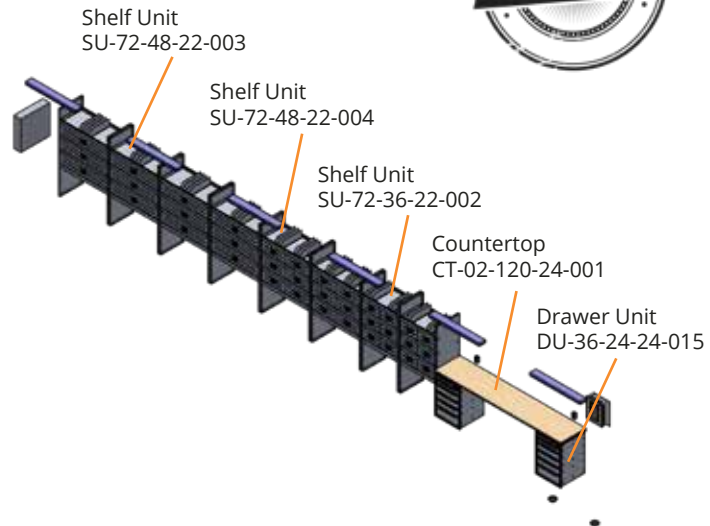
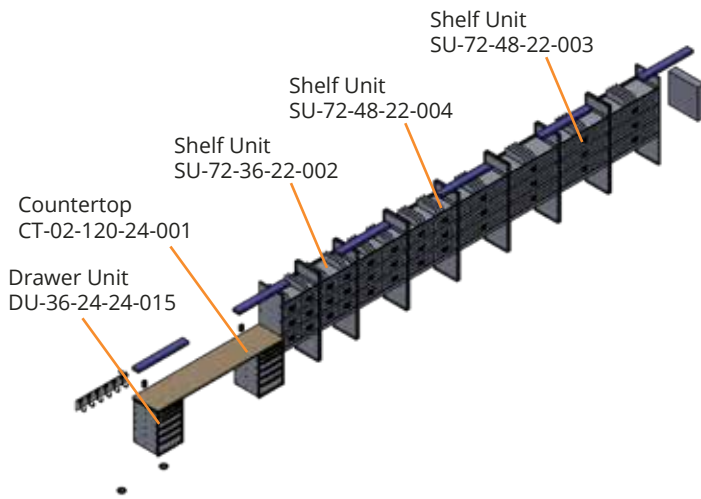

DRIVER SIDE

ITEM	PART #	QTY
Drawer Unit	DU-36-24-24-015	2
Countertop	CT-02-120-24-001	1
Shelf Unit	SU-72-36-22-002	2
Shelf Unit	SU-72-48-22-004	2
Shelf Unit	SU-72-48-22-003	4

PASSENGER SIDE

ITEM	PART #	QTY
Shelf Unit	SU-72-48-22-003	4
Shelf Unit	SU-72-48-22-004	2
Shelf Unit	SU-72-36-22-002	2
Countertop	CT-02-120-24-001	1
Drawer Unit	DU-36-24-24-015	2

FEATURES:

EXTERIOR:

- 2x weatherproof GFCI plugs
- 1x perimeter enhancement white scene light
- Removable staircase with handrails
- Exhaust ventilation fan

INTERIOR:

- 6x swivel hooks
- 4x tie-down rings, 6000LBS capacity
- 1x 30A shore power plug
- 4x standard electrical outlets
- 6x 110V vaportight LED lights
- Electrical panel, 100A/8CT
- Aluminum panel backer



48' TRAILER

PACKAGE NUMBER: 7052

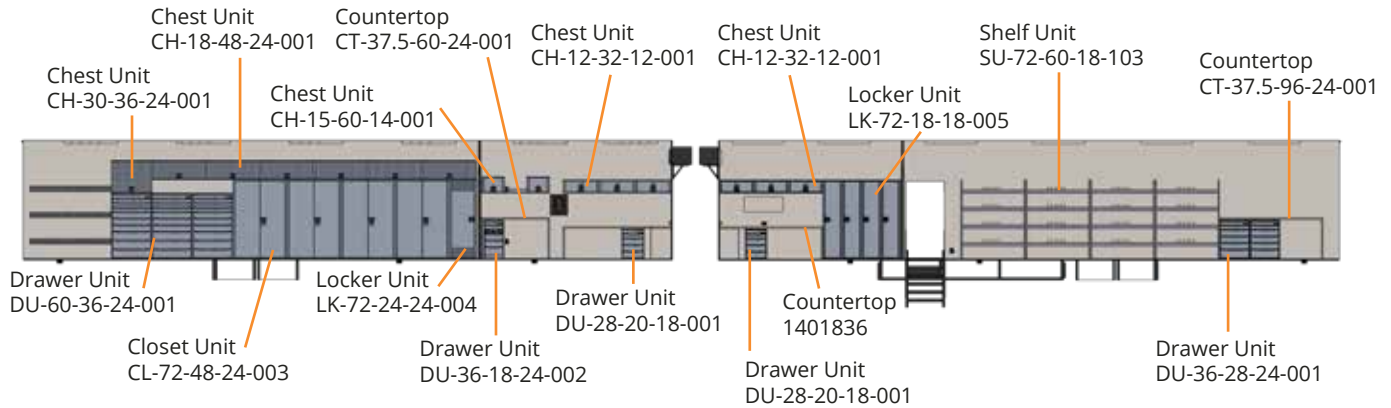

DRIVER SIDE

ITEM	PART #	QTY
Drawer Unit	DU-60-36-24-001	3
Chest Unit	CH-30-36-24-001	1
Chest Unit	CH-18-48-24-001	6
Closet Unit	CL-72-48-24-003	4
Locker Unit	LK-72-24-24-004	1
Chest Unit	CH-15-60-14-001	2
Drawer Unit	DU-36-18-24-002	1
Countertop	CT-37.5-60-24-001	1
Chest Unit	CH-12-32-12-001	3
Drawer Unit	DU-28-20-18-001	1

PASSENGER SIDE

ITEM	PART #	QTY
Drawer Unit	DU-28-20-18-001	1
Chest Unit	CH-12-32-12-001	3
Countertop	1401836	1
Locker Unit	LK-72-18-18-005	4
Shelf Unit	SU-72-60-18-103	4
Drawer Unit	DU-36-28-24-001	2
Countertop	CT-37.5-96-24-001	1

FEATURES:

EXTERIOR:

- 8x weatherproof GFCI outlets
- 10x 12V LED white scene lights
- Air conditioner
- Shore power
- 2x underbody cabinets
- Underbody storage for ramp and staircase

INTERIOR:

- 6x armor mat on floor
- 6x 110V LED lights
- 6x 15A outlets
- Electrical panel - 100A / 8CT
- Partition wall
- Plywood walls
- Trim kit
- 3x E-Track



53' TRAILER

PACKAGE NUMBER: 4390

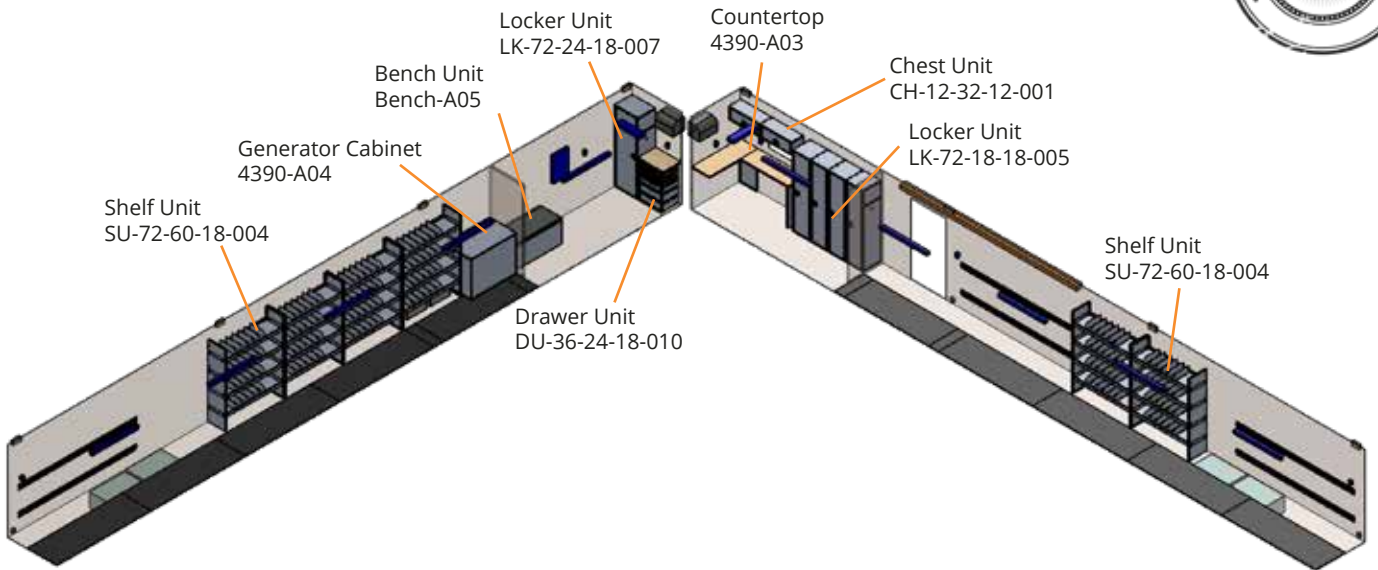

DRIVER SIDE

ITEM	PART #	QTY
Shelf Unit	SU-72-60-18-004	4
Generator Cabinet	4390-A04	1
Bench Unit	Bench-A05	1
Locker Unit	LK-72-24-18-007	1
Drawer Unit	DU-36-24-18-010	1

PASSENGER SIDE

ITEM	PART #	QTY
Countertop	4390-A03	1
Chest Unit	CH-12-32-12-001	2
Locker Unit	LK-72-18-18-005	4
Shelf Unit	SU-72-60-18-004	2

FEATURES:

EXTERIOR:

- 53'L x 13'H enclosed trailer
- Low Pro 22.5 tires
- Tandem axles
- Rear barn doors
- 8x scene lights
- 8x outlets
- 4x underbody cabinets
- 15' awning
- Air conditioner

INTERIOR:

- Armor mat flooring
- 4x E-Track on passenger side
- 2x E-Track on driver side
- 6x 48" LED lights
- 10x outlets
- Electrical panel



53' TRAILER

PACKAGE NUMBER: 7270

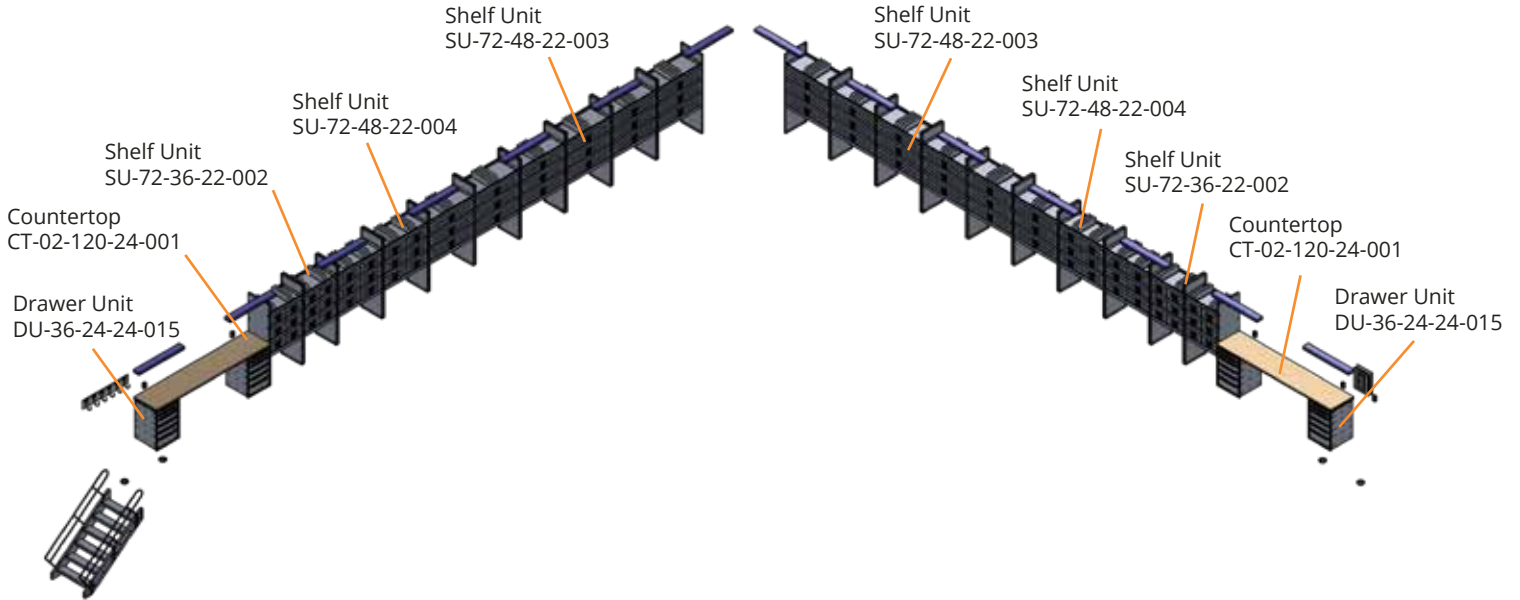

DRIVER SIDE

ITEM	PART #	QTY
Drawer Unit	DU-36-24-24-015	2
Countertop	CT-02-120-24-001	1
Shelf Unit	SU-72-36-22-002	2
Shelf Unit	SU-72-48-22-004	2
Shelf Unit	SU-72-48-22-003	4

PASSENGER SIDE

ITEM	PART #	QTY
Drawer Unit	DU-36-24-24-015	2
Countertop	CT-02-120-24-001	1
Shelf Unit	SU-72-36-22-002	2
Shelf Unit	SU-72-48-22-004	2
Shelf Unit	SU-72-48-22-003	4

FEATURES:

INTERIOR:

- LED lighting
- 30A/125V shore power
- 4x 15A outlets
- Electrical panel, 100A / 8CT
- 7x 110V vaportight LED lights
- D-rings in floor
- 6x swivel hooks



53' TRAILER

PACKAGE NUMBER: 5295

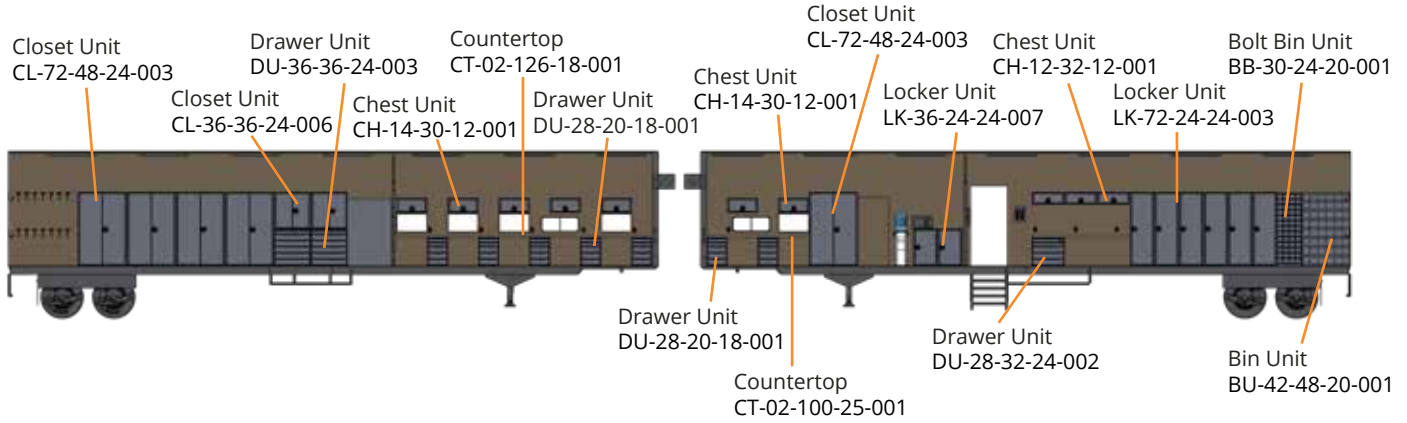

DRIVER SIDE

ITEM	PART #	QTY
Closet Unit	CL-72-48-24-003	4
Closet Unit	CL-36-36-24-006	2
Drawer Unit	DU-36-36-24-003	2
Chest Unit	CH-14-30-12-001	5
Countertop	CT-02-126-18-001	2
Drawer Unit	DU-28-20-18-001	5

PASSENGER SIDE

ITEM	PART #	QTY
Drawer Unit	DU-28-20-18-001	2
Chest Unit	CH-14-30-12-001	2
Countertop	CT-02-100-25-001	1
Closet Unit	CL-72-48-24-003	1
Locker Unit	LK-36-24-24-007	2
Drawer Unit	DU-28-32-24-002	1
Chest Unit	CH-12-32-12-001	3
Locker Unit	LK-72-24-24-003	6
Bolt Bin Unit	BB-30-24-20-001	1
Bin Unit	BU-42-48-20-001	1

FEATURES:

EXTERIOR:

- 53' enclosed trailer
- 14,000 BTU air conditioner, roof mounted
- Removable staircase with storage bracket

INTERIOR:

- 1/4" white plywood on walls and ceiling
- 3/4" black plywood with hex pattern
- 48" LED lights
- 100A shore power plug
- 3x wall fan forced zonal heater
- GFI outlets with USB
- Whiteboard
- Partition with swing door
- Refrigerator
- Microwave



53' TRAILER

PACKAGE NUMBER: 6531

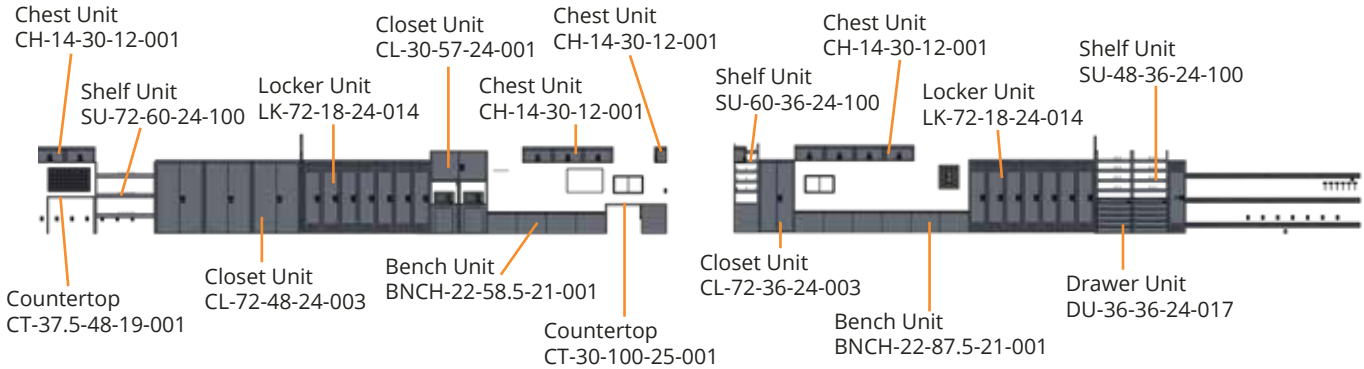

DRIVER SIDE

ITEM	PART #	QTY
Chest Unit	CH-14-30-12-001	2
Countertop	CT-37.5-48-19-001	1
Shelf Unit	SU-72-60-24-100	1
Closet Unit	CL-72-48-24-003	3
Locker Unit	LK-72-18-24-014	7
Closet Unit	CL-30-57-24-001	1
Bench Unit	BNCH-22-58.5-21-001	4
Chest Unit	CH-14-30-12-001	3
Countertop	CT-30-100-25-001	1
Chest Unit	CH-14-30-12-001	2

PASSENGER SIDE

ITEM	PART #	QTY
Shelf Unit	SU-60-36-24-100	1
Closet Unit	CL-72-36-24-003	1
Chest Unit	CH-14-30-12-001	4
Bench Unit	BNCH-22-87.5-21-001	6
Locker Unit	LK-72-18-24-014	8
Drawer Unit	DU-36-36-24-017	2
Shelf Unit	SU-48-36-24-100	2

FEATURES:

EXTERIOR:

- 100A generator panel
- Electrical outlets
- Shore power outlets
- 3 ton air conditioner/heater

INTERIOR:

- Partition wall
- 6x swivel hooks
- 14x 15A outlets with USB charger
- 10x vaportight LED lights
- 1/4" white plywood walls
- 3/4" black plywood floors with hex pattern
- Trim kit
- 6x E-Track
- 48" x 24" peg board
- Mini fridge
- 24" x 36" whiteboard
- 4x tie-down rings
- Insulation in walls



53' TRAILER

PACKAGE NUMBER: 7624

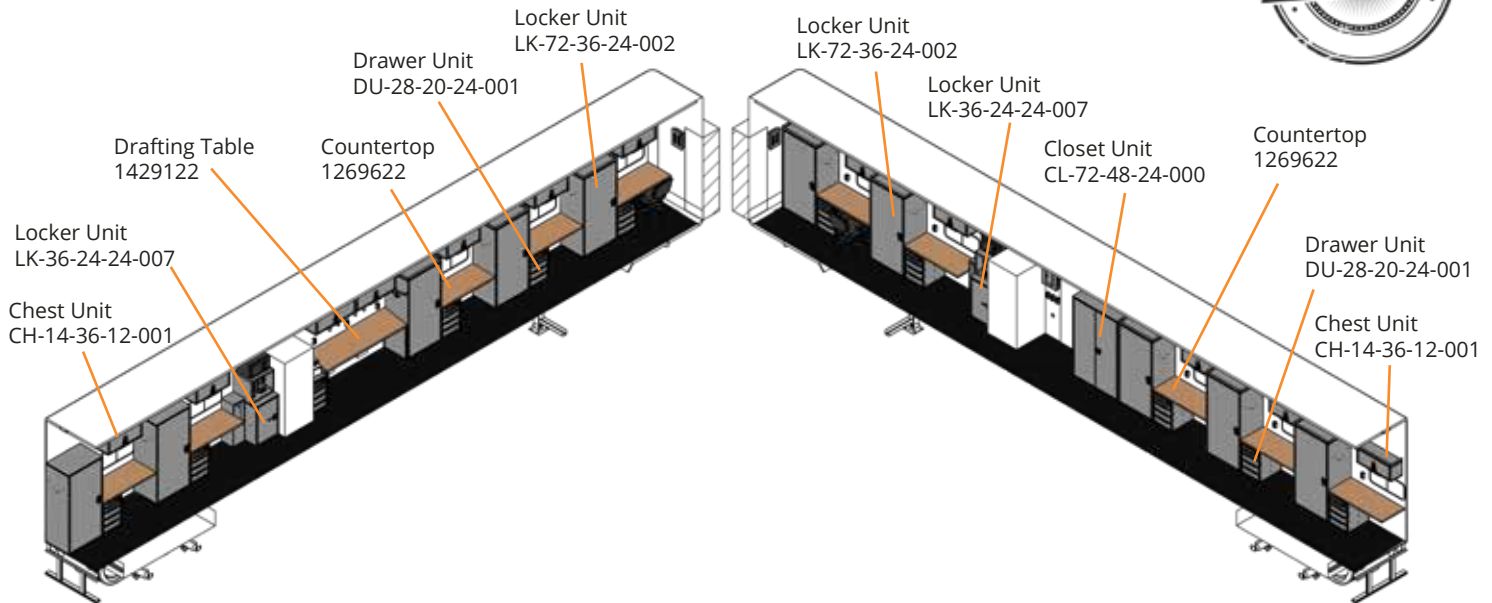

DRIVER SIDE

ITEM	PART #	QTY
Chest Unit	CH-14-36-12-001	5
Locker Unit	LK-72-36-24-002	5
Drafting Table	1429122	1
Countertop	1269622	5
Drawer Unit	DU-28-20-24-001	6
Locker Unit	LK-36-24-24-007	1

PASSENGER SIDE

ITEM	PART #	QTY
Locker Unit	LK-72-36-24-002	5
Locker Unit	LK-36-24-24-007	1
Closet Unit	CL-72-48-24-000	1
Countertop	1269622	5
Drawer Unit	DU-28-20-24-001	5
Chest Unit	CH-14-36-12-001	5

FEATURES:

EXTERIOR:

- Swing barn back doors
- 3x scene lights
- Removable staircase with storage under deck

INTERIOR:

- Insulated walls and ceiling
- 1/4" white smooth plywood on walls and ceiling
- 3/4" floor - black plywood with ABS and hex texture
- 14x 48" LED lights
- 4x wall mounted fan forced zonal heaters
- 3-ton air conditioner
- 15A/120V electrical outlets w/ USB port per workstation
- Sliding window per workstation
- 12V light per workstation
- 2x microwave, 2x full fridge, and 2x water dispenser
- 100A/240V shore power plug w/ storage for cable
- 100A/32 circuit space electrical panel
- 5x swivel hooks above drafting table



ACCESSORIES

Add any of our standard accessories to your upfit. Have another accessory in mind? As your one-source provider, we will provide anything you need to complete your mobile workspace.



RUBBER MATTING

Add rubber matting to minimize sliding and noise inside cabinets and drawers.

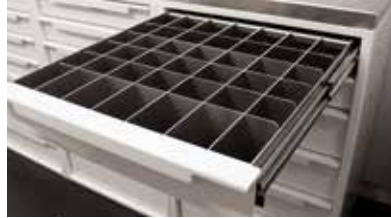

DRAWER DIVIDERS

Add side-to-side, front-to-back, or egg crate dividers to any drawer.



LARGE HOOKS

Store jackets or equipment such as cables and cords on large hooks.



ADJUSTABLE SHELVING

Adjustable shelving allows you to customize the height of your shelves.



PERFORATED DOORS

Improve drying times of contents, or better air flow for hot sticks.



WHITEBOARDS

Add whiteboards to your design to improve your mobile office.





CONTACT US:

20400 Old Rome State Road
Watertown, NY 13601
315.595.3300

638 Fortune Crescent
Kingston, ON K7P 2T3
613.530.3419

ezstak.com

ABOUT US:

Over 21 years experience and knowledge, our manufacturing process ensures predictable, accurate, and superior quality builds. We are dedicated to providing the best mobile workspace solutions to our valued customers.

